

Operator's Manual

Walk-Behind Roller

RS600A



EN

5000402583	06	0314
------------	----	------

Copyright notice

© Copyright 2014 by Wacker Neuson Corporation.

All rights, including copying and distribution rights, are reserved.

This publication may be photocopied by the original purchaser of the machine. Any other type of reproduction is prohibited without express written permission from Wacker Neuson Corporation.

Any type of reproduction or distribution not authorized by Wacker Neuson Corporation represents an infringement of valid copyrights. Violators will be prosecuted.

Trademarks

All trademarks referenced in this manual are the property of their respective owners.

Manufacturer

Wacker Neuson Manila Incorporated

Lot 2, Blk 1 Phase 3, PEZA Drive, First Cavite Industrial Estate, Brgy. Langkaan
Dasmariñas, Cavite, Philippines 4126

Tel: +63-(0)2-580-7136 Fax: +63-(0)2-580-7122

www.wackerneuson.com

Original instructions

This Operator's Manual presents the original instructions. The original language of this Operator's Manual is American English.

Foreword

SAVE THESE INSTRUCTIONS—This manual contains important instructions for the machine models listed below. These instructions must be followed during installation and maintenance of the machine (and battery, if equipped).

Machines covered in this manual

Machine	Item Number
RS600A	0630010

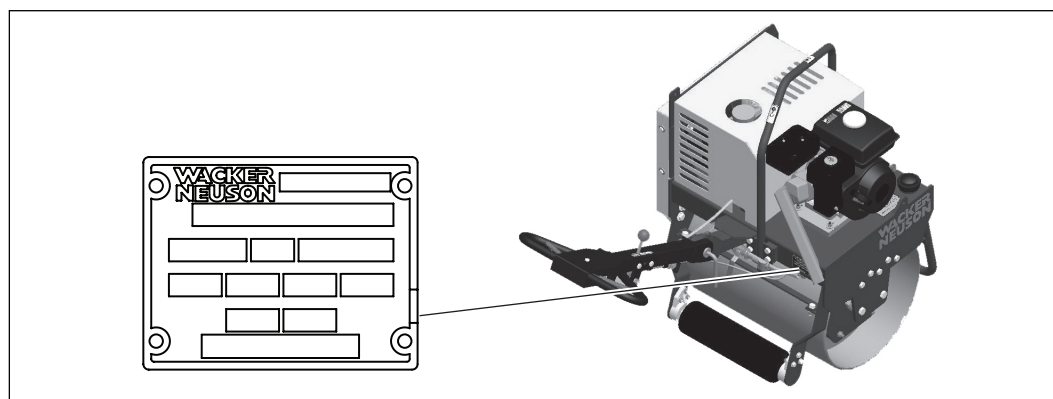

wpm_gr011229

Machine identification

A nameplate listing the model number, item number, revision number, and serial number is attached to this machine. The location of the nameplate is shown above.

Serial number (S/N)

For future reference, record the serial number in the space provided below. You will need the serial number when requesting parts or service for this machine.

Serial Number:

Machine documentation

- From this point forward in this documentation, Wacker Neuson Manila Inc. will be referred to as Wacker Neuson.
- Keep a copy of the Operator's Manual with the machine at all times.
- Use the separate Parts Book supplied with the machine to order replacement parts.
- If you are missing any of these documents, please contact Wacker Neuson to order a replacement or visit www.wackerneuson.com.

When ordering parts or requesting service information, be prepared to provide the machine model number, item number, revision number, and serial number.

Expectations for information in this manual

- This manual provides information and procedures to safely operate and maintain the above Wacker Neuson model(s). For your own safety and to reduce the risk of injury, carefully read, understand, and observe all instructions described in this manual.
- Wacker Neuson expressly reserves the right to make technical modifications, even without notice, which improve the performance or safety standards of its machines.
- The information contained in this manual is based on machines manufactured up until the time of publication. Wacker Neuson reserves the right to change any portion of this information without notice.
- The illustrations, parts, and procedures in this manual refer to Wacker Neuson factory-installed components. Your machine may vary depending on the requirements of your specific region.

CALIFORNIA Proposition 65 Warning

Combustion exhaust, some of its constituents, and certain vehicle components contain or emit chemicals known to the State of California to cause cancer and birth defects or other reproductive harm.

Manufacturer's approval

This manual contains references to *approved* parts, attachments, and modifications. The following definitions apply:

- **Approved parts or attachments** are those either manufactured or provided by Wacker Neuson.
- **Approved modifications** are those performed by an authorized Wacker Neuson service center according to written instructions published by Wacker Neuson.
- **Unapproved parts, attachments, and modifications** are those that do not meet the approved criteria.

Unapproved parts, attachments, or modifications may have the following consequences:

- Serious injury hazards to the operator and persons in the work area
- Permanent damage to the machine which will not be covered under warranty

Contact your Wacker Neuson dealer immediately if you have questions about approved or unapproved parts, attachments, or modifications.

Foreword	3
1 Safety Information	7
1.1 Signal Words Used in this Manual	7
1.2 Machine Description and Intended Use	8
1.3 Operating Safety	9
1.4 Operator Safety while Using Internal Combustion Engines	12
1.5 Service Safety	13
2 Labels	15
2.1 Label Locations	15
2.2 Label Meanings	16
3 Lifting and Transporting	19
4 Operation	21
4.1 Preparing the Machine for First Use	21
4.2 Recommended Fuel	21
4.3 Operation and Service Locations	22
4.4 Application	23
4.5 Before Starting	23
4.6 Starting	24
4.7 To Stop	24
4.8 Direction and Speed Control	25
4.9 Exciter (Vibration) Control	26
4.10 Watering System	26
4.11 Handle Adjustment	27
4.12 Operation on Slopes.....	28
4.13 Tip-Overs.....	29

5	Maintenance	29
5.1	Periodic Maintenance Schedule	29
5.2	Lubrication	30
5.3	Servicing the Spark Plug	31
5.4	Servicing the Air Cleaner	32
5.5	Changing the Engine Oil	33
5.6	Adjusting the Carburetor	34
5.7	Cleaning the Sediment Cup	35
5.8	Scraper Bars	35
5.9	Cleaning the Machine.....	36
6	Troubleshooting	37
7	Technical Data	39
7.1	Engine	39
7.2	Machine	40
7.3	Lubrication.....	40
8	Dimensions	41

1 Safety Information

1.1 Signal Words Used in this Manual

This manual contains DANGER, WARNING, CAUTION, *NOTICE*, and NOTE signal words which must be followed to reduce the possibility of personal injury, damage to the equipment, or improper service.



This is the safety alert symbol. It is used to alert you to potential personal hazards.
► Obey all safety messages that follow this symbol.



DANGER

DANGER indicates a hazardous situation which, if not avoided, will result in death or serious injury.

- To avoid death or serious injury from this type of hazard, obey all safety messages that follow this signal word.



WARNING

WARNING indicates a hazardous situation which, if not avoided, could result in death or serious injury.

- To avoid possible death or serious injury from this type of hazard, obey all safety messages that follow this signal word.



CAUTION

CAUTION indicates a hazardous situation which, if not avoided, could result in minor or moderate injury.

- To avoid possible minor or moderate injury from this type of hazard, obey all safety messages that follow this signal word.

NOTICE: Used without the safety alert symbol, NOTICE indicates a situation which, if not avoided, could result in property damage.

Note: A Note contains additional information important to a procedure.

1.2 Machine Description and Intended Use

The Wacker Neuson walk behind roller offers functionality and performance. The compact design allows for covering of small patch-work processes.

This machine is a lightweight single drum handheld rollers are widely used in asphalt applications for small jobs for road maintenance. It has:

- Adjustable and foldable handle, which is convenient for transportation and compact usage and for excellent operator visibility of sight lines.
- Simplified water system for easy cleaning and reduce downtime; includes in-line water filter.
- Large anti-rust coated water tank that eliminates several stops for refilling.
- Beveled edged front and rear bar that supports and keeps the roller balanced to prevent it from scuffing and gouging of asphalt surfaces.
- Automatic braking system in forward and reverse motion.
- Front tie-downs to secure the machine to the trailer.
- Introduces a travel speed which is suitable for easy movement.
- Optimize drum wall thickness and drum diameter for long service life and to prevent deformation.
- With roller chain drive for a more efficient transmission system and high gradeability.

This machine has been designed and built strictly for the intended use described above. Using the machine for any other purpose could permanently damage the machine or seriously injure the operator or other persons in the area. Machine damage caused by misuse is not covered under warranty.

The following are some examples of misuse:

- Using the machine as a ladder, support, or work surface
- Using the machine to carry or transport passengers or equipment
- Operating the machine outside of factory specifications
- Operating the machine in a manner inconsistent with all warnings found on the machine and in the Operator's Manual.

This machine has been designed and built in accordance with the latest global safety standards. It has been carefully engineered to eliminate hazards as far as practicable and to increase operator safety through protective guards and labeling. However, some risks may remain even after protective measures have been taken. They are called residual risks. On this machine, they may include exposure to:

- Heat, noise, exhaust, and carbon monoxide from the engine
- Fire hazards from improper refueling techniques
- Fuel and its fumes
- Personal injury from improper lifting techniques

To protect yourself and others, make sure you thoroughly read and understand the safety information presented in this manual before operating the machine.

1.3 Operating Safety

Operator training

Before operating the machine:

- Read and understand the operating instructions contained in all manuals delivered with the machine.
- Familiarize yourself with the location and proper use of all controls and safety devices.
- Contact Wacker Neuson for additional training if necessary.

When operating this machine:

- Do not allow improperly trained people to operate the machine. People operating the machine must be familiar with the potential risks and hazards associated with it.

Only trained personnel are permitted to start, operate, and shut down the machine. They also must meet the following qualifications:

- have received instruction on how to properly use the machine
- are familiar with required safety devices

The machine must not be accessed or operated by:

- children
 - people impaired by alcohol or drugs
-

Application area

Be aware of the application area.

- Keep unauthorized personnel, children, and pets away from the machine.
- Remain aware of changing positions and the movement of other equipment and personnel in the application area/job site.

Be aware of the application area.

- Do not operate the machine in areas that contain flammable objects, fuels, or products that produce flammable vapors.
-

Safety devices, controls, and attachments

Only operate the machine when:

- All safety devices and guards are in place and in working order.
- All controls operate correctly.
- The machine is set up correctly according to the instructions in the Operator's Manual.
- The machine is clean.
- The machine's labels are legible.

To ensure safe operation of the machine:

- Do not operate the machine if any safety devices or guards are missing or inoperative.
 - Do not modify or defeat the safety devices.
 - Only use accessories or attachments that are approved by Wacker Neuson.
-

Safe operating practices

When operating this machine:

- Remain aware of the machine's moving parts. Keep hands, feet, and loose clothing away from the machine's moving parts.

When operating this machine:

- Do not operate a machine in need of repair.

Personal Protective Equipment (PPE)

Wear the following Personal Protective Equipment (PPE) while operating this machine:

- Close-fitting work clothes that do not hinder movement
- Safety glasses with side shields
- Hearing protection
- Safety-toed footwear

Transporting and installing the machine

- Never allow untrained personnel to operate or service the vibrator plate.
- Do not stand under the machine while it is being hoisted or moved.
- Do not attach equipment to the machine when it is suspended.
- Always transport the machine in an upright position.
- Always position and operate the machine on a firm, noncombustible, level surface.
- Always make certain the machine is well-grounded and securely fastened to a good earthen ground per national and local regulations.

General Safety

- Do not operate the machine when open containers of fuel, paint, or other flammable liquids are near.
- Do not operate the machine, or tools attached to the machine, with wet hands..
- Do not enclose or cover the machine when it is in use or when it is hot.
- Do not operate the machine in snow, rain, or standing water.
- Do not stand on the machine.

Machine vibration

Vibratory plate vibrate in normal use. During and after the use of the machine, inspect the machine before storing it.

- Have damaged items repaired or replaced as necessary.

After use

- Store the machine properly when it is not being used. The machine should be stored in a clean, dry location out of the reach of children.

Cleaning

When cleaning and servicing the machine:

- Keep the machine clean and free of debris such as leaves, paper, cartons, etc.
- Keep the labels legible.

When cleaning the machine:

- Do not clean the machine while it is running.
- Never use gasoline or other types of fuels or flammable solvents to clean the machine. Fumes from fuels and solvents can become explosive.

1.4 Operator Safety while Using Internal Combustion Engines



WARNING

Internal combustion engines present special hazards during operation and fueling. Failure to follow the warnings and safety standards could result in severe injury or death.

- Read and follow the warning instructions in the engine owner's manual and the safety guidelines below.
-

Refueling safety

When refueling the engine:

- Do not smoke.
- Do not refuel if the machine is sitting in a truck fitted with a plastic bed liner. Static electricity can ignite the fuel or fuel vapors.
- Do not refuel a hot or running engine.
- Do not refuel the engine near an open flame.

When refueling the engine, always:

- Refill the fuel tank in a well-ventilated area.
 - Replace the fuel tank cap after refueling.
-

Operating safety

When operating the machine:

- Check the fuel lines and the fuel tank for leaks and cracks before starting the engine.
- Do not run the machine if fuel leaks are present or the fuel lines are loose.
- Do not run the engine near open flames.
- Do not start the engine if fuel has spilled or a fuel odor is present. Move the machine away from the spill and wipe it dry before starting.
- Do not smoke while operating the machine.

1.5 Service Safety

Service training

Before servicing or maintaining the machine:

- Read and understand the instructions contained in all manuals delivered with the machine.
- Familiarize yourself with the location and proper use of all controls and safety devices.
- Only trained personnel shall troubleshoot or repair problems occurring with the machine.
- Contact Wacker Neuson for additional training if necessary.

When servicing or maintaining this machine:

- Do not allow improperly trained people to service or maintain the machine. Personnel servicing or maintaining the machine must be familiar with the associated potential risks and hazards.

Precautions

Follow the precautions below when servicing or maintaining the machine.

- Read and understand the service procedures before performing any service to the machine.
- All adjustments and repairs must be completed before operating the machine. Do not operate the machine with a known problem or deficiency.
- All repairs and adjustments shall be completed by a qualified technician.
- Turn off the machine before performing maintenance or making repairs.
- Remain aware of the machine's moving parts. Keep hands, feet, and loose clothing away from the machine's moving parts.
- Re-install the safety devices and guards after repair and maintenance procedures are complete.

Machine modifications

When servicing or maintaining the machine:

- Use only accessories/attachments that are approved by Wacker Neuson.

When servicing or maintaining the machine:

- Do not defeat safety devices.
- Do not modify the machine without the express written approval of Wacker Neuson.

Replacing parts and labels

- Replace worn or damaged components.
- Replace all missing and hard-to-read labels.
- When replacing electrical components, use components that are identical in rating and performance to the original components.
- When replacement parts are required for this machine, use only Wacker Neuson replacement parts or those parts equivalent to the original in all types of specifications, such as physical dimensions, type, strength, and material.

Cleaning

When cleaning and servicing the machine:

- Keep the machine clean and free of debris such as leaves, paper, cartons, etc.
- Keep the labels legible.

When cleaning the machine:

- Do not clean the machine while it is running.
 - Never use gasoline or other types of fuels or flammable solvents to clean the machine. Fumes from fuels and solvents can become explosive.
-

**Personal
Protective
Equipment
(PPE)**

Wear the following Personal Protective Equipment (PPE) while servicing or maintaining this machine:

- Close-fitting work clothes that do not hinder movement
- Safety glasses with side shields
- Hearing protection
- Safety-toed footwear

In addition, before servicing or maintaining the machine:

- Tie back long hair.
 - Remove all jewelry (including rings).
-

Precautions

- Always turn the engine off before servicing the machine. If the engine has electric start, disconnect the negative terminal on the battery before servicing the machine.
- Always let the engine cool before transporting or servicing the machine.



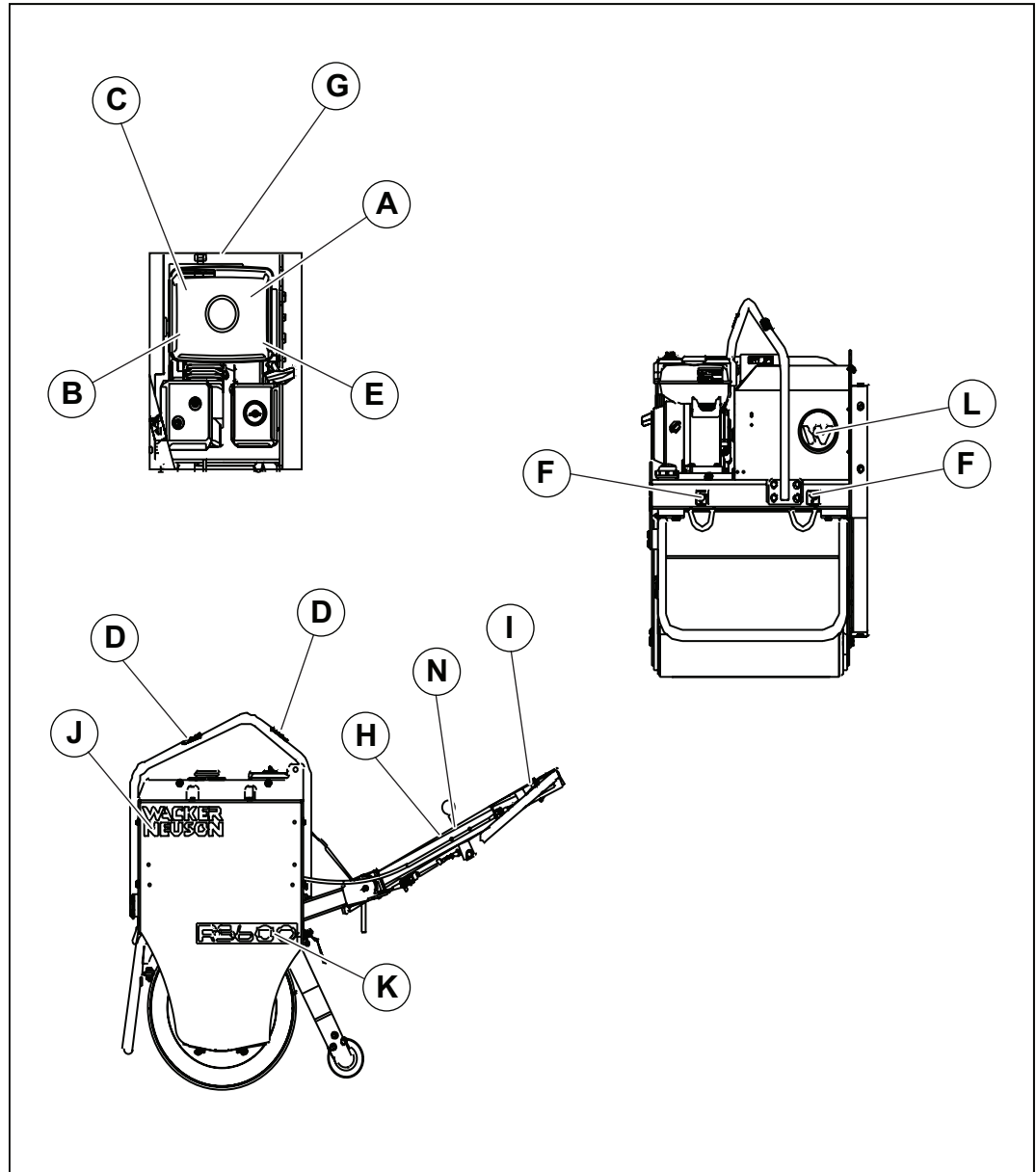

2 Labels



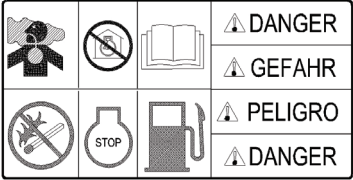

2.1 Label Locations



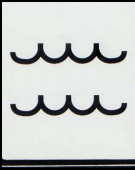
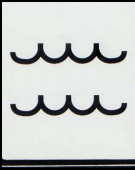
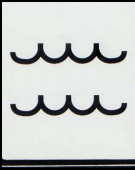

wpm_gr007604

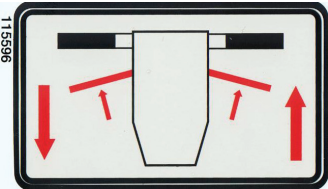
2.2 Label Meanings

A	 <p>117034</p>	<p>Engines emit carbon monoxide; operate only in well-ventilated area. Read the operator's Manual</p> <p>No sparks, flames, or burning objects near the machine. Shut off the engine before refueling.</p>
B	 <p>117038</p> <p>117037</p>	<p>WARNING</p> <p>Hot surface</p>
C	 <p>117045</p>	<p>CAUTION</p> <p>Read and understand the supplied Operator's Manual before operating this machine. Failure to do so increases the risk of injury to yourself and others.</p>
D	 <p>111418</p>	<p>NOTICE</p> <p>Lifting point</p>
E	 <p>116130</p>	<p>WARNING!</p> <p>To prevent hearing loss, wear hearing protection when operating this machine.</p>

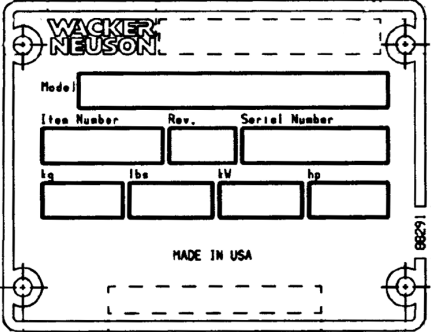
F		Tie down point					
G	<table border="1"><tr><td rowspan="4"></td><td>WATER TANK</td></tr><tr><td>WASSERTANK</td></tr><tr><td>TANQUE PARA AGUA</td></tr><tr><td>RESERVOIR D'EAU</td></tr></table>		WATER TANK	WASSERTANK	TANQUE PARA AGUA	RESERVOIR D'EAU	Water tank
	WATER TANK						
	WASSERTANK						
	TANQUE PARA AGUA						
	RESERVOIR D'EAU						
H		Vibration control ON/OFF					
I		Control Lever: Forward and reverse motion controlled by red levers.					
J		Company label					
K		Machine label					

L		Company logo
M		<p>A nameplate listing the model number, item number, revision number, and serial number is attached to each unit. Please record the information found on this nameplate so it will be available should the nameplate become lost or damaged. When ordering parts or requesting service information, you will always be asked to specify the model number, item number, revision number, and serial number of the unit.</p>
N		<p>Throttle control lever: Turtle = Idle or Slow Rabbit = Full or Fast</p>

3 Lifting and Transporting

Lifting the Machine

This machine is heavy enough to cause injury if proper lifting techniques are not used. Observe the following guidelines when lifting the machine.

- Do not attempt to lift the machine unassisted. Use appropriate lifting equipment such as slings, chains hooks, ramps or jacks.
- Make sure lifting equipment is attached securely and has enough weight-bearing capacity to lift or hold the machine safely.
- Remain aware of the location of other people nearby when lifting the machine.

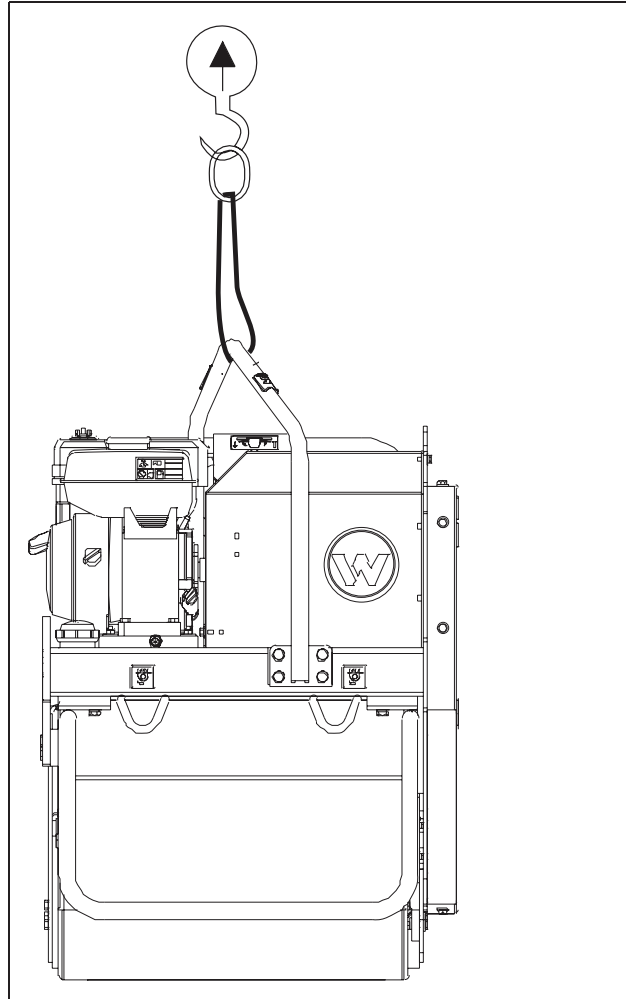

wpmgr007602

Transporting the Machine

Observe the following guidelines when transporting the roller to and from the job site.

- Drain the fuel tank before transporting the machine.
- Ensure that the machine is securely strapped down in the transport vehicle to prevent it from sliding or tipping.
- Do not refuel the machine in or on the transport vehicle. Move the machine to its operating location and then fill the fuel tank.
- Before transporting the machine, place blocks in front of and behind each drum. Use the front tie-downs (**a**) to secure the machine to the trailer. Lift handle into upright position.

**CAUTION**

Never use any other part of the roller to tie the machine down, as severe damage may occur.

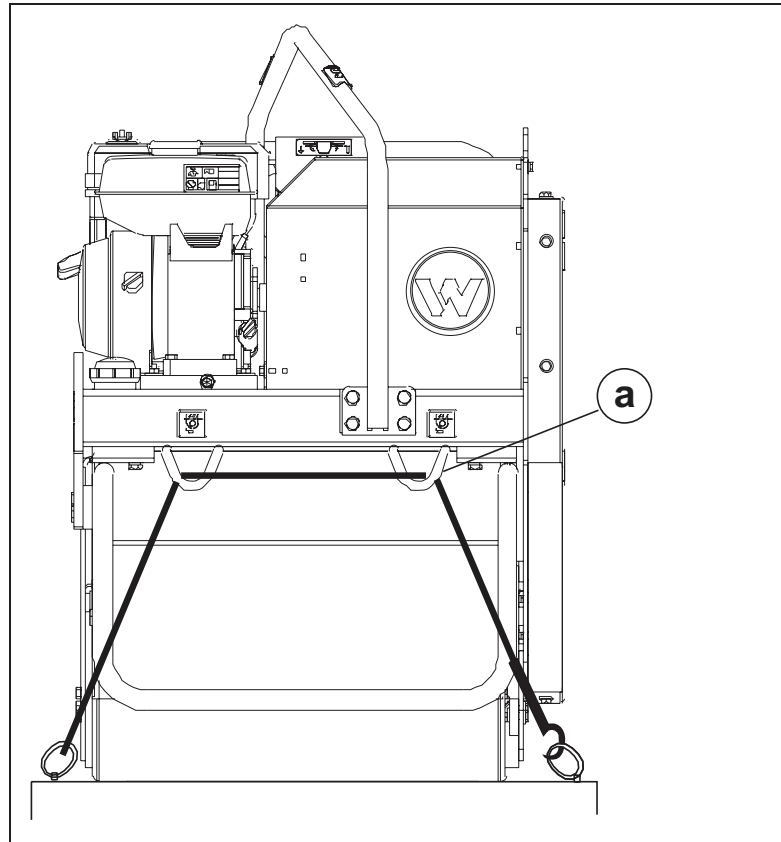

wpmgr007603

4 Operation

4.1 Preparing the Machine for First Use

- Procedure** Perform the procedure below to prepare the machine.
1. Make sure all loose packaging materials have been removed from the machine.
 2. Check the machine and its components for damage. If there is visible damage, do not operate the machine! Contact your Wacker Neuson dealer immediately for assistance.
 3. Take inventory of all items included with the machine and verify that all loose components and fasteners are accounted for.
 4. Attach component parts not already attached.
 5. Add fluids as needed and applicable, including fuel, engine oil, and battery acid.
 6. Move the machine to its operating location.

4.2 Recommended Fuel

The engine requires regular grade unleaded gasoline. Use only fresh, clean gasoline. Gasoline containing water or dirt will damage the fuel system. Consult the engine owner's manual for complete fuel specifications.

Use of oxygenated fuels

Some conventional gasolines are blended with alcohol. These gasolines are collectively referred to as oxygenated fuels. If you use an oxygenated fuel, be sure it is unleaded and meets the minimum octane rating requirement.

Before using an oxygenated fuel, confirm the fuel's contents. Some states and provinces require this information to be posted on the fuel pump.

Ethanol

The following is the Wacker Neuson approved percentage of oxygenates:

(Ethyl or grain alcohol) 10% by volume. You may use gasoline containing up to 10% ethanol by volume (commonly referred to as E10). Gasoline containing more than 10% ethanol (such as E15, or E85) may not be used because it could damage the engine.

If you notice any undesirable operating symptoms, try another service station, or switch to another brand of gasoline.

Fuel system damage or performance problems resulting from the use of an oxygenated fuel containing more than the percentages of oxygenates above are not covered under warranty.

4.3 Operation and Service Locations

Ref	Description	Ref	Description
1	Handle lock pin	6	Forward/reverse control lever
2	Sprinkler tube	7	Exciter control
3	Water control valve	8	Water fill cap
4	Scraper bar	9	Fuel tank
5	Tie-down	10	Lifting eye

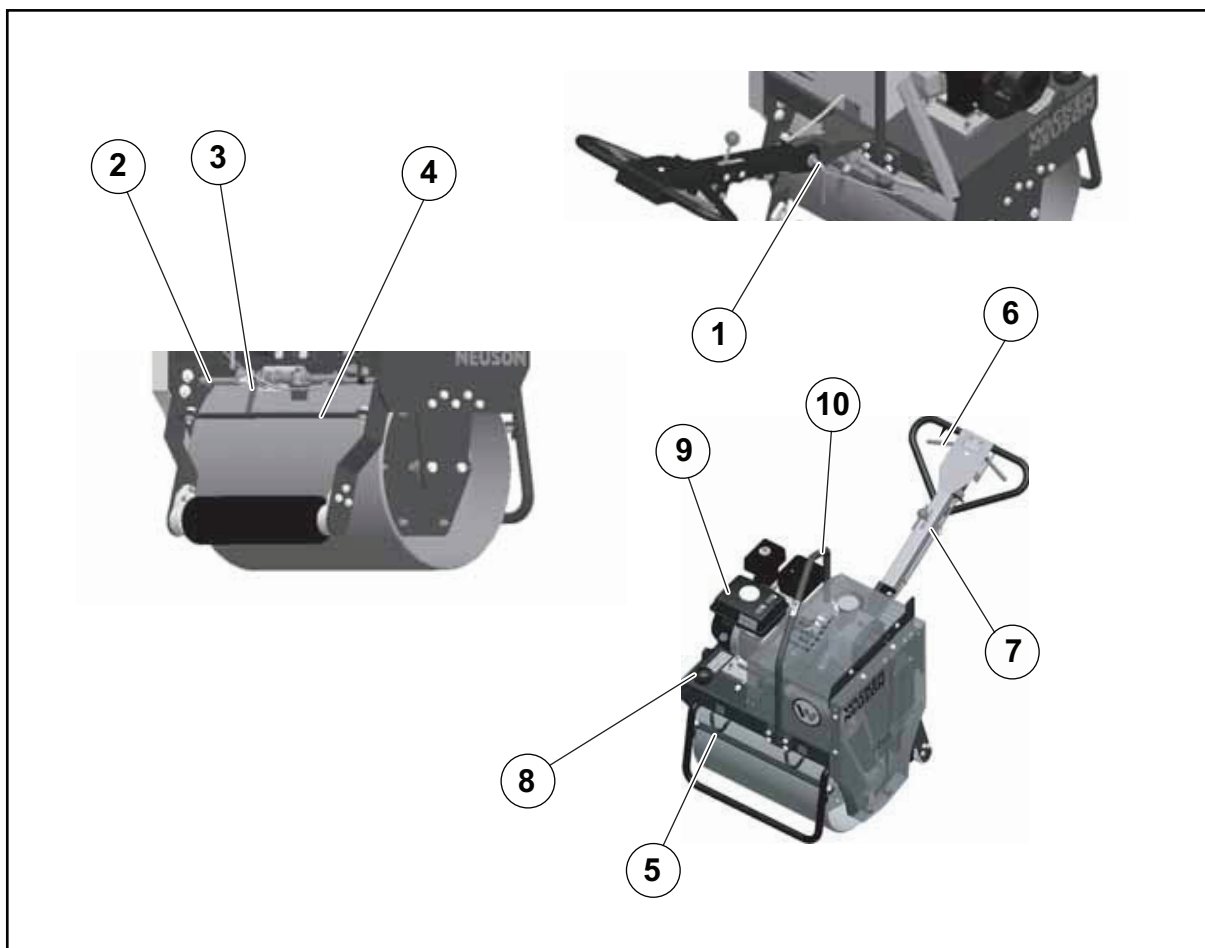

wpm_gr007595

4.4 Application

Overview This machine is designed for compaction of sand, gravel, soil and asphalt. The RS 600A has tight clearances, making it ideally suited for small repairs and maintenance of roads, walks, bridges, and parking lots. The high exciter forces ensure excellent compaction of cohesive-type soils, as well as loose soils and gravel. The sprinkler system and water control valve allow the roller to be used wet or dry.

4.5 Before Starting

Read and understand the safety and operating instructions at the beginning of this manual.

- Check**
- Oil level in the engine
 - Fuel level
 - Condition of the air cleaner
 - Tightness of the external fasteners
 - Condition of the fuel lines

4.6 Starting

Procedure

Perform the procedure below to start the engine

1. Open the fuel valve by moving lever to the right (**a1**).

Note: If engine is cold, move choke lever to close position (**b1**), if engine is hot, set choke to open position (**b2**).

2. Turn the engine switch to "ON" (**e1**).
3. Pull the starter rope (**c**).

Note: If the oil level in the engine is low, the engine will not start. If this happens, add oil to engine. Some engines are equipped with an oil alert light (**f**) that will come on while pulling the starter rope.

4. Open the choke (**b2**) as engine warms.
5. Open the throttle (**g1**) fully to operate.

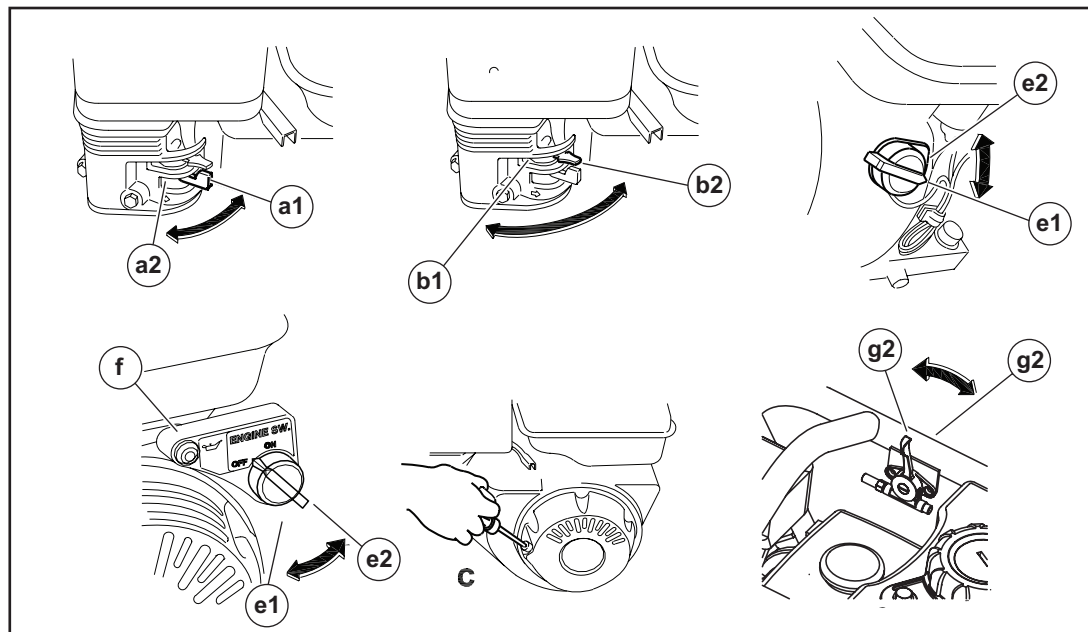

wpm_gr007337

Result

The machine is now ready

4.7 To Stop

Procedure

Perform the following procedures to stop the engine.

1. Reduce the engine rpm to idle by moving the throttle completely to the left (**g2**).
2. Turn the engine switch to "OFF" (**e2**)
3. Close the fuel valve by moving the lever to the left (**a2**).

4.8 Direction and Speed Control

Procedure Perform the following procedure in controlling the speed and direction.

1. Travel direction and speed is controlled by the travel lever. To move in the forward direction, pull (toward the operator) on the right side **(a)** of the travel lever.
2. To move in the reverse direction, pull (toward the operator) the left side **(b)** of the travel lever. The further toward the operator the lever is pulled, the faster the machine will travel. When neither side of the travel lever is pulled, the travel lever is spring-centered to the stopped position.



CAUTION

Keep both hands on the guide handle while operating the machine. The guide handle may pivot rapidly when the machine changes travel direction. This sudden movement of the guide handle can cause injury if the guide handle is not under control.

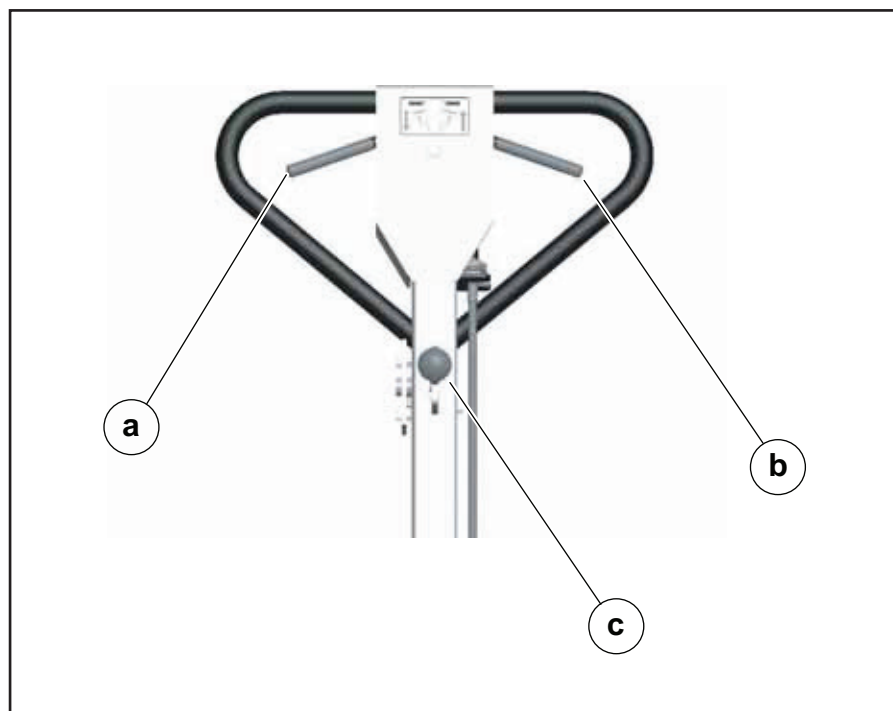

wpm_gr007596

4.9 Exciter (Vibration) Control

Background The exciter provides the vibration and can be used in most applications involving cohesive-type soils with heavy clay content, as well as loose soils and gravel.

The vibration is controlled by the lever **(c)** on the guide handle. Moving the lever forward turns the vibration ON and reverse to turn the vibration OFF.



CAUTION

Do not run machine with the vibration on over hard surfaces like concrete or compacted asphalt. The drum bearings can be damaged.

4.10 Watering System

Background The RS 600A is equipped with a water control valve **(a)** which allows the roller to be used wet or dry, and a sprinkler system **(b)** to distribute the water evenly across the drum. The water is gravity fed from the water tank **(c)** through the filter **(d)** to the sprinkler when the control valve is in the open position (shown closed).

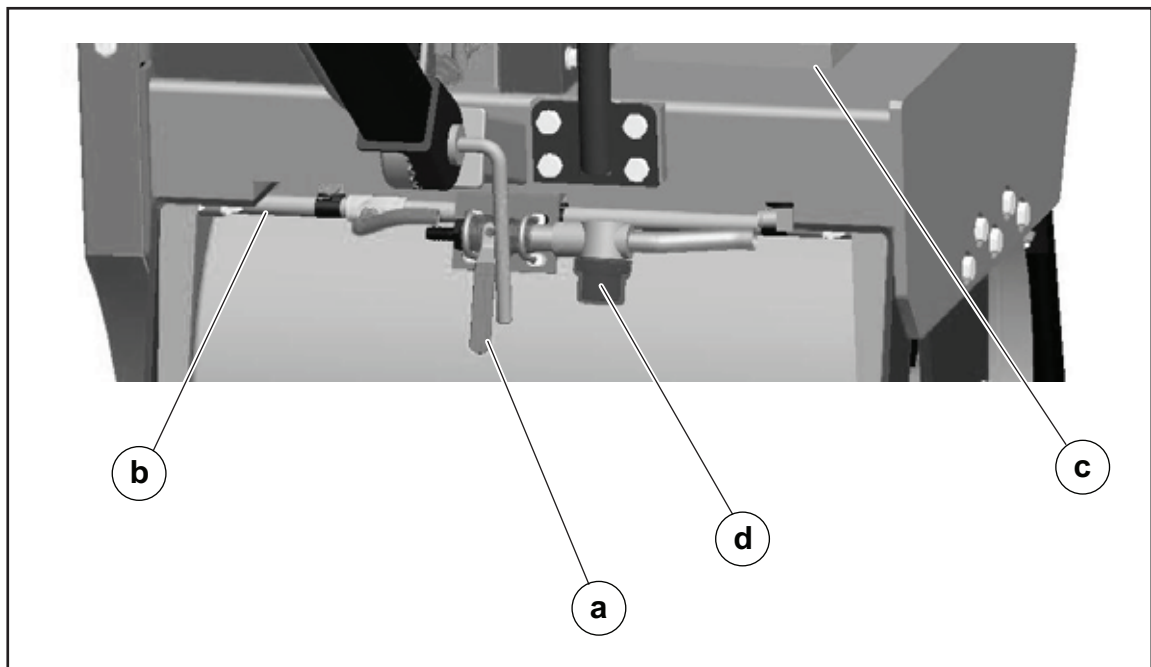

wpm_gr007597

4.11 Handle Adjustment

Background The handle is adjustable to various angles required for different applications and to improve operator comfort. The handle rotates vertically for convenient transportation and storage.

**CAUTION**

Support the handle at all times during adjustment. To avoid injury, NEVER position yourself directly under the handle.

Procedure Perform the following procedure in adjusting the handle.

1. Rotate the lever **(a)** clock-wise to loosen the coupling then adjust the handle at the desired height and position. Secure the coupling by turning the lever **(a)** counter-clockwise.

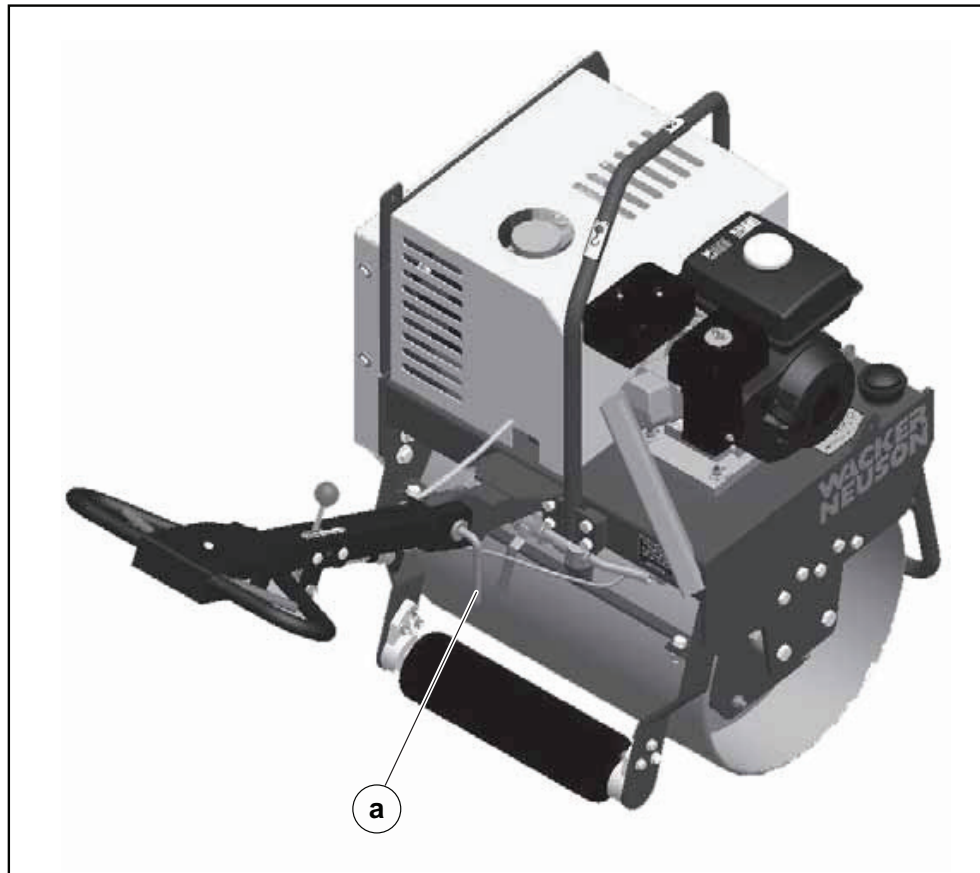

wpm_gr007598

4.12 Operation on Slopes

Remember When operating on slopes or hills, special care must be taken to reduce the risk of personal injury or damage to the equipment. Always operate the machine up and down hills rather than from side to side. For safe operation and for protection of the engine, continuous duty use should be restricted to front/rear slopes of 9° (15% grade) or less.



WARNING

Do not operate the machine sideways on slopes. The machine may roll over, even on stable ground.

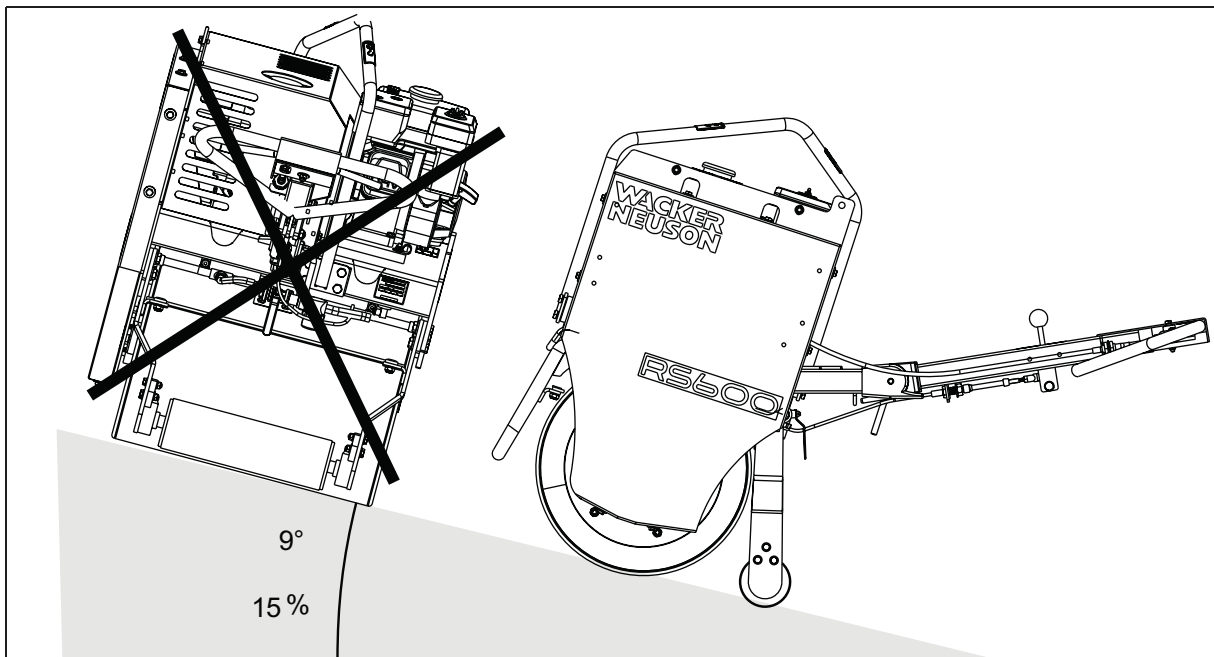

wpm_gr011224

4.13 Tip-Overs

Remember Proper operation of the machine on slopes will prevent rollovers. If a machine tip-over does occur, care must be taken to prevent damage to the engine. In this position, oil from the engine crankcase can flow into the combustion chamber, which can severely damage the engine next time it is started. If the machine has rolled on its side, **immediate** steps should be taken to right the machine.

NOTICE: To prevent damage to the engine after a tip-over, the machine must NOT be started, AND must be serviced to remove any oil that may have been trapped in the combustion chambers. Contact your local Wacker Neuson dealer for instructions or servicing.

5 Maintenance

5.1 Periodic Maintenance Schedule

Engine Maintenance

The chart below lists basic engine maintenance. Refer to the engine manufacturer's Operation manual additional information.

Engine	Daily before starting	After first 20 hr	Every 50 hr	Every 100 hr	Every 300 hr
Check the fuel level.	■				
Check the engine oil level.	■				
Inspect the air filter. Replace as needed	■				
Check the external hardware.	■				
Clean the air element			■		
Inspect the shockmounts for damage				■	
Change the engine oil		■		■	
Clean the sediment cup or fuel strainer.				■	
Check and clean the spark plug.				■	
Check and adjust the valve clearance.					■
Clean the fuel tank					■
Check the condition of the fuel lines. Replace when necessary.					■
<i>Service more frequently in dusty conditions.</i>					

Machine Maintenance

The chart below lists basic machine maintenance.

Machine	Daily before starting	After first 20 hr	Every 50 hr	Every 100 hr	Every 300 hr
Check the external hardware	■				
Check and adjust the scraper bars				■	
Check the oil in hydrostatic transmission				■	
Check the shockmounts; replace if cracked or split					■
Change the oil in the gear case					■

NOTICE: When the machine is being used on asphalt, it is highly recommended that shockmounts are replaced every year or after 300 hours of usage.

5.2 Lubrication

Check

Check the oil level in the hydrostatic drive **(a)** when the machine is cold. Fill the reservoir as needed with SAE 20W-20 engine crankcase oil. Suitable substitutes are SAE 30, SAE 40 or premium hydraulic oil as long as the viscosity is equivalent to that of SAE 20W-20.

Note: Do not mix the engine oil and the hydraulic oil.

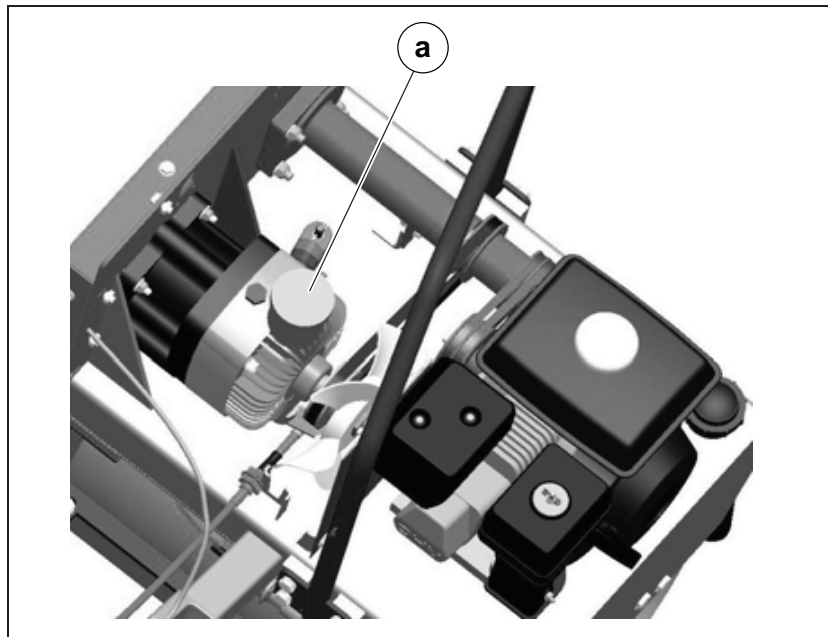

wpmgr007600

5.3 Servicing the Spark Plug

Clean or replace the spark plug as needed to ensure proper operation. Refer to your engine operator's manual.

**WARNING**

The muffler becomes very hot during operation and remains hot for a while after stopping the engine. Do not touch the muffler while it is hot.

NOTICE: Refer to section “*Technical Data*” for the recommended spark plug type and the electrode gap.

Procedure

Perform the procedure below to service the spark plug.

1. Remove the spark plug and inspect it.
2. Replace the spark plug if the insulator is cracked or chipped.
3. Clean the spark plug electrodes with a wire brush.
4. Set the electrode gap (a).
5. Tighten the spark plug securely.

NOTICE: A loose spark plug can become very hot and may cause engine damage.

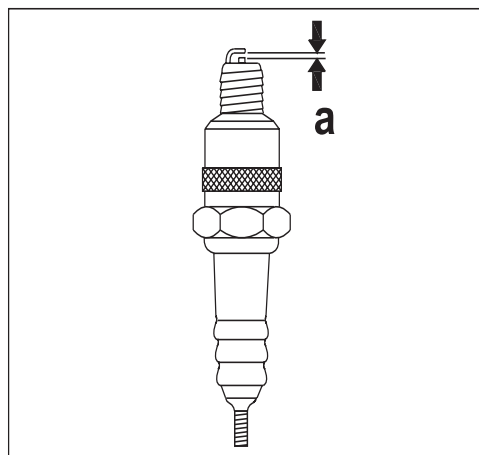

wc_gr000028

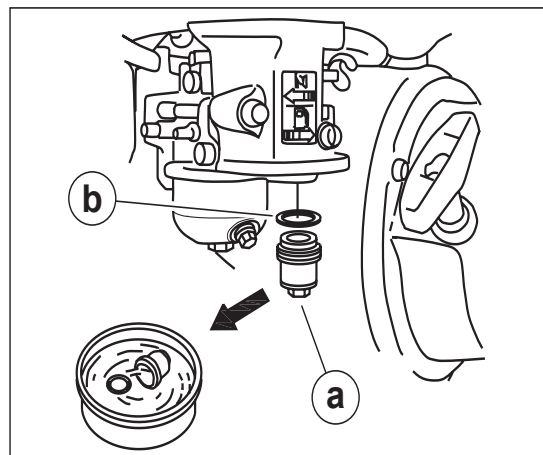

wc_gr000029

Result

The spark plug has now been cleaned and checked.

5.4 Servicing the Air Cleaner

Background A dirty air filter element can restrict air flowing into the carburetor. To keep the carburetor in good working conditions, service the air filter element periodically. If operating the engine in extremely dusty area, the job should be done more often.

**WARNING**

Explosion hazard and fire hazard.

- Do not clean the air filter element with gasoline or low-flash point detergents.

NOTICE: Do not run the engine without an air filter element; doing so will damage the engine.

Procedure Perform the procedure below to service the air filter element.

1. Remove air cleaner cover **(a)**. Remove both elements and inspect them for holes or tears. Replace damaged elements
2. Wash foam element **(b)** in solution of mild detergent and warm water. Rinse thoroughly in clean water. Allow element to dry thoroughly. Soak element in clean engine oil and squeeze out excess oil.
3. Tap paper element **(c)** lightly to remove excess dirt. Replace paper element if it appears heavily soiled.

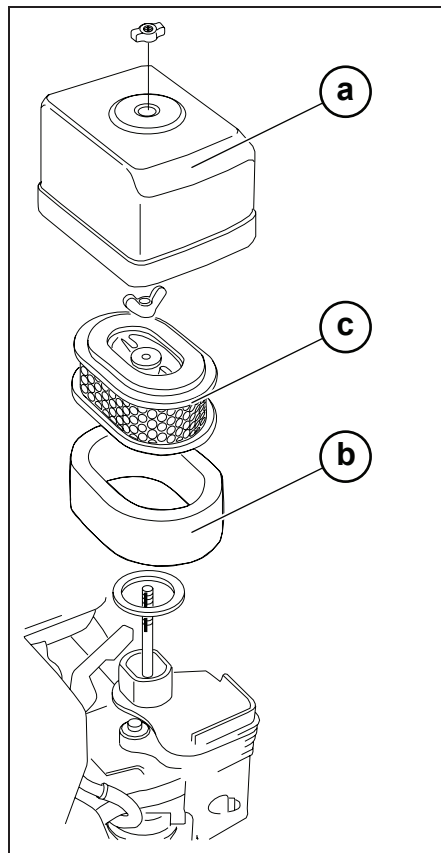

wc_gr000025

5.5 Changing the Engine Oil

Requirement The requirements for this procedure are:

- Engine warm
- Fresh oil

Procedure Perform the procedure below to change the engine oil.

1. Drain the oil while the engine is still warm.
2. Remove the oil filter plug (a) and the drain plug (b) to drain the oil.

Note: *In the interest of environmental protection, place a plastic sheet and a container under the machine to collect any liquid that drains off. Dispose of this liquid in accordance with environmental protection legislation.*

3. Install the drain plug.
4. Fill the engine crankcase with the recommended oil up to the level of the lug opening (c). See chapter *Technical Data* for oil quantity and type.
5. Install the oil filler plug.

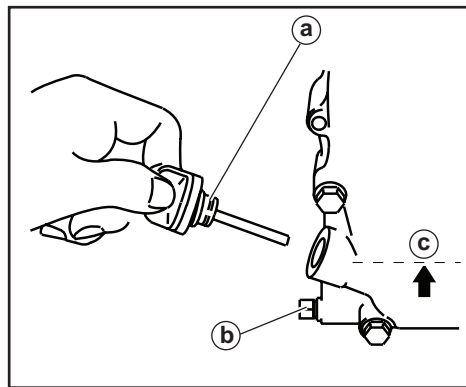

wc_gr000028

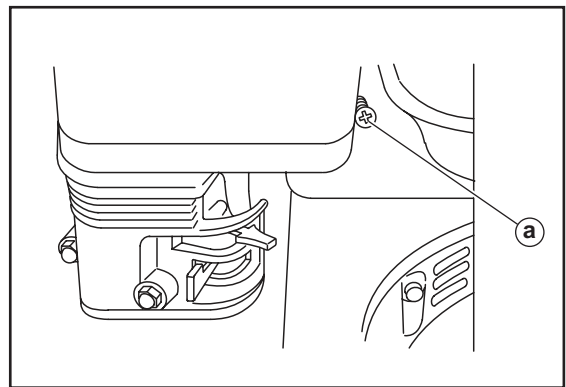

wc_gr000022

5.6 Adjusting the Carburetor

Procedure Perform the procedure below to adjust the carburetor.

1. Start the engine and allow it to warm up to operating temperature.
2. Set the pilot screw **(a)** two turns out. See *Note*.
3. With the engine idling, turn the pilot screw **(a)** in or out to the setting that produces the highest rpm.
4. After the pilot screw is adjusted, turn the throttle stop screw **(b)** to obtain the standard idle speed. See *Technical Data*.

Note: On some engines the pilot screw is fitted with a limiter cap **(c)** to prevent excessive enrichment of the air-fuel mixture in order to comply with emission regulations. The mixture is set at the factory and no adjustment should be necessary. Do not attempt to remove the limiter cap. The limiter cap cannot be removed without breaking the pilot screw.

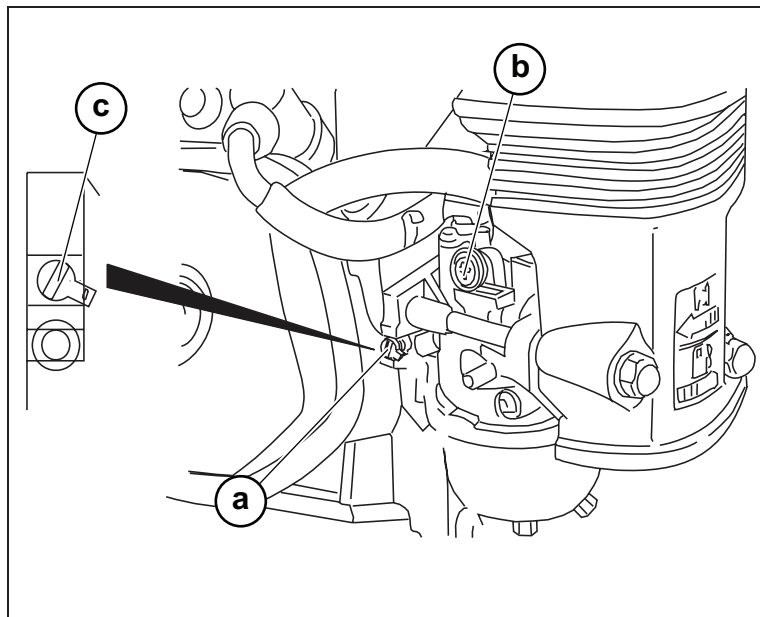

wc_gr000032

5.7 Cleaning the Sediment Cup

- Procedure** Perform the procedure below in cleaning the sediment cup.
1. Turn the fuel valve off.
 2. Remove the sediment cup **(a)** and the O-ring **(b)**.
 3. Wash both thoroughly in a non-flammable solvent. Dry and re-install them.
 4. Turn the fuel valve on and check for leaks.

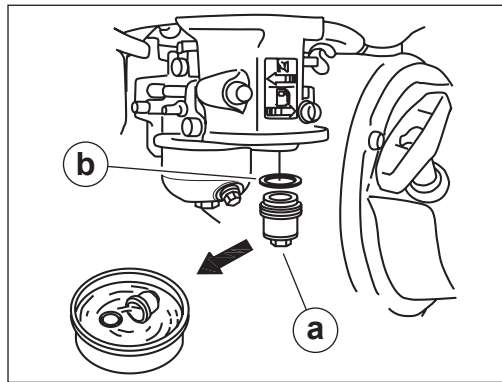

wc_gr000029

5.8 Scraper Bars

- Check** Check the two scraper bars **(a)** for wear. Scraper bars are made of metal which can wear quickly when used with abrasive materials. Replace scraper bars as needed.

- How to clean** The scraper bars should be cleaned daily after use or as often as needed to remove built-up dirt, mud, and tar.
- Use a high-pressure water jet and a strong brush if needed.

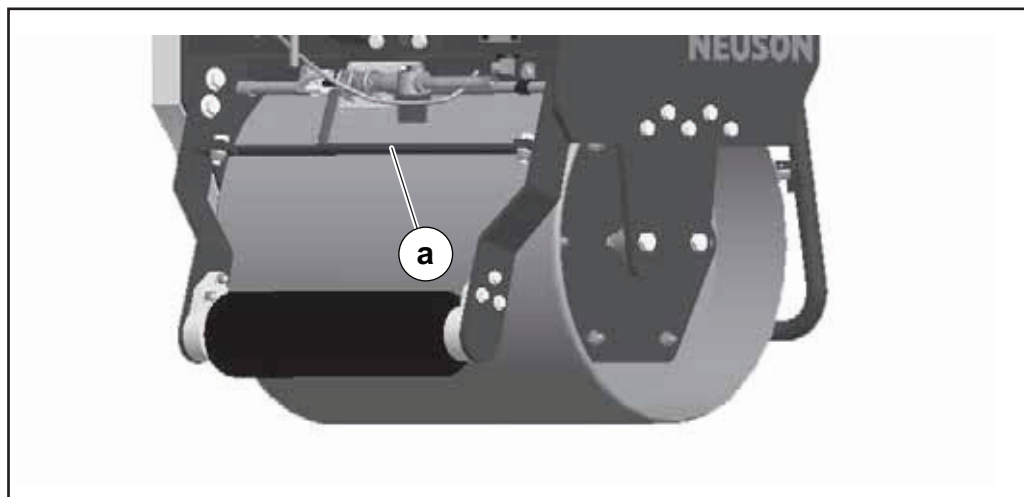

wpmgr007601

5.9 Cleaning the Machine

Remember When pressure washing the machine, avoid using harsh chemicals and only use moderate water pressure (500–1000 psi).

Avoid direct pressure to the following components:

- Engine
- Hoses
- Labels

5.10 Storage

Procedure If the machine is being stored for more than 30 days:

1. Remove loose stones and dirt from the plate.
2. Clean engine cylinder cooling fins.
3. Clean or replace air filter element.
4. Change the exciter oil.
5. Change the engine oil and follow procedures described in engine manual for engine storage.
6. Cover the machine and store in a clean and dry area.

6 Troubleshooting

Problem	Cause	Remedy
Engine will not start	<ul style="list-style-type: none"> No fuel No spark Low oil level 	<ul style="list-style-type: none"> Fill the fuel tank and open the fuel valves. Connect the spark plug and/or replace it. Fill the engine with oil
Engine runs erratically	<ul style="list-style-type: none"> Dirty air cleaner No fuel Dirty engine Drum is obstructed Too much oil in exciter 	<ul style="list-style-type: none"> Clean the air filter Check the fuel level. Open the fuel valve. Remove deposits built up in the engine Remove the drum obstruction
Drum does not rotate	<ul style="list-style-type: none"> The hydrostatic transmission is not engaged Drive belt is loose or broken Faulty hydrostatic transmission Control linkage is disconnected or broken Shaft keys are sheared 	<ul style="list-style-type: none"> Check/repair the hydrostatic transmission release valve and camshaft. Tighten or replace the belt. Check the transmission oil level. Fill the gear case with oil. Check the transmission oil level. Fill the gear case with oil. Connect or repair the control linkage. Replace the shaft keys. Check the function of actuator lever on the transmission and the drive pulleys.
Drum does not vibrate	<ul style="list-style-type: none"> Exciter belt is broke Improper clutch adjustment Control linkage is disconnected or broken 	<ul style="list-style-type: none"> Replace the exciter belt Correct the clutch adjustment Connect or repair the linkage
Drum does not return to neutral	<ul style="list-style-type: none"> Neutral position on the transmission is not set. 	<ul style="list-style-type: none"> Adjust the neutral position on the transmission.

Problem	Cause	Remedy
Roller operates erratically	<ul style="list-style-type: none"> • Clutch is worn • Incorrect belt tension • Faulty pulley mounts • Faulty linkages • Exciter bearings binding • Gear case bearings binding or gears are jammed • Faulty hydrostatic transmission 	<ul style="list-style-type: none"> • Check the waer and damaged clutch or the loose fasteners. • Check the belt tension. Replace the worn or damaged belts. • Tighten the set screws and the other mounting hardware. • Check the controls, linkages and connections. • Grease or replace the exciter bearings. • Rebiuld the gear case. • Check the transmission oil level and the temperature.

7 Technical Data

7.1 Engine Data

Engine Power Rating

Net power rating per SAE J1349. Actual power output may vary due to conditions of specific use.

		RS600A
Engine		
Engine make		Honda
Engine model		GX 160 UT1 SWX2
Maximum rated power at rated speed	kW (hp)	3.7 (5) @ 3600 rpm
Spark plug		NGK BPR 6ES
Electrode gap	mm (in.)	0.7–0.8 (0.028–0.031)
Operating speed	rpm	3600
Air cleaner	type	Dual element
Engine lubrication	oil grade	SAE 10W-30, SG or SF
Engine oil capacity	ml (oz.)	580 (20)
Fuel	type	Regular unleaded gasoline
Fuel tank capacity	L (gal)	3.1 (3.3)
Valve clearance (cold) Inlet: Outlet:	mm. (in.)	0.15 (0.006) 0.20 (0.008)

7.2 Machine Data

		RS600A
Roller		
Weight	kg (lbs.)	260 (573)
Forward speed (max.)	m (ft.) / min.	42.67 (140)
Reverse speed (max.)	m (ft.) / min.	42.67 (140)
Vibration frequency	Hz (vpm)	90 (5400)
Gradeability	%	20
Water tank capacity	l (gal)	18.4 (4.8)

7.3 Lubrication

		RS600A
Lubrication		
Hydrostatic transmission		SAE 10W30 Class SE

8 Dimensions

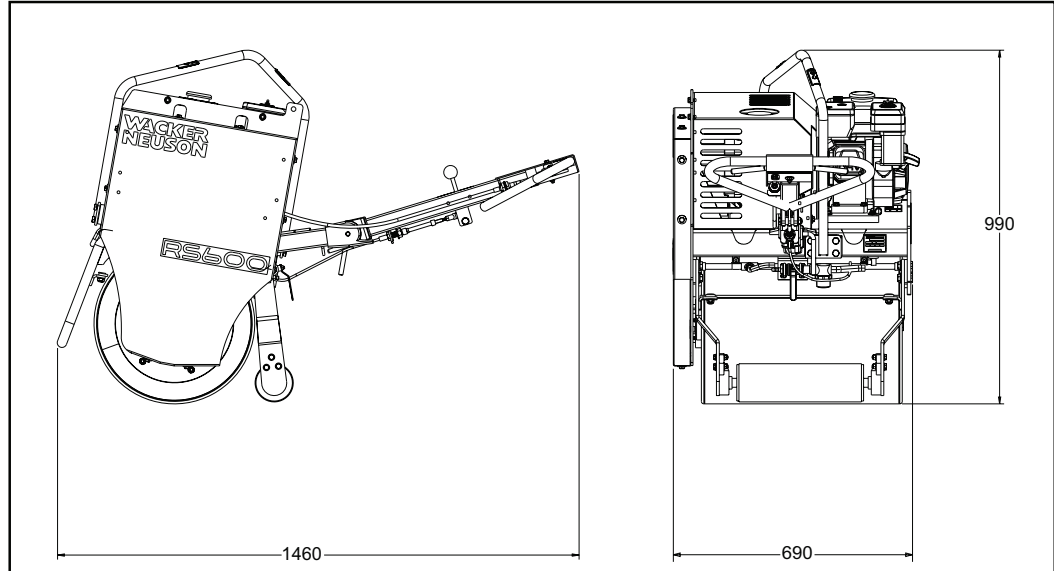

wpm_gr011248

Important: For spare parts information, please see your Wacker Neuson Dealer, or visit the Wacker Neuson website at <http://www.wackerneuson.com/>.

Wichtig! Informationen über Ersatzteile erhalten Sie von Ihrem Wacker Neuson Händler oder besuchen Sie die Wacker Neuson Website unter <http://www.wackerneuson.com/>.

Important : Pour des informations sur les pièces détachées, merci de consulter votre distributeur Wacker Neuson, ou de visiter le site Internet de Wacker Neuson sur <http://www.wackerneuson.com/>.

Importante : Para saber más sobre las piezas de repuesto, póngase en contacto con su distribuidor de Wacker Neuson o acceda al sitio web de Wacker Neuson en <http://www.wackerneuson.com/>.

Importante : Per informazioni sui pezzi di ricambio, contattare il rivenditore Wacker Neuson o visitare il sito di Wacker Neuson all'indirizzo www.wackerneuson.com.

Viktigt : För information om reservdelar, kontakta din Wacker Neuson-leverantör eller besök Wacker Neusons webbplats på <http://www.wackerneuson.com/>.

Tärkeää : Pyydä varaosatieitoja Wacker Neusonin jälleenmyyjältä tai vieraile Wacker Neusonin web-sivustolla osoitteessa <http://www.wackerneuson.com/>

Viktig : For informasjon om reservedeler, vennligst kontakt din Wacker Neuson-forhandler, eller besøk Wacker Neusons nettside på <http://www.wackerneuson.com/>.

Viktigt : Hvis du ønsker oplysninger om reservedele, bedes du kontakte din Wacker Neuson forhandler eller besøg Wacker Neuson websiden på <http://www.wackerneuson.com/>.

Belangrijk! Neem contact op met uw Wacker Neuson dealer of bezoek de website van Wacker Neuson op <http://www.wackerneuson.com/> voor meer informatie over reserveonderdelen.

Importante : Para obter informações sobre as peças sobresselentes, consulte o seu fornecedor da Wacker Neuson ou acesse ao site Web da Wacker Neuson em http://www.wackerneuson.com

Ważne : W celu uzyskania informacji na temat części zamiennych skontaktuj się z przedstawicielem firmy Wacker Neuson lub skorzystaj z witryny internetowej <http://www.wackerneuson.com/>.

Důležité upozornění! Pro informace o náhradních dílech, prosím, kontaktujte svého Wacker Neuson dealera, nebo navštivte webové stránky <http://www.wackerneuson.com/>.

FONTOS: A pótalkatrészekre vonatkozó információért kérjük, forduljon Wacker Neuson kereskedőjéhez vagy látogasson el a Wacker Neuson weboldallára a következő címen: <http://www.wackerneuson.com/>.

Важно! Для ознакомления с информацией о запасных частях, пожалуйста, обратитесь к местному торговому представителю компании Wacker Neuson или посетите веб-сайт <http://www.wackerneuson.com/>.

Σημαντικό : Για πληροφορίες σχετικά με τα ανταλλακτικά, μιλήστε με τον αντιπρόσωπό σας της Wacker Neuson, ή επισκεφθείτε τον ιστότοπο <http://www.wackerneuson.com/>.

Važno : Za rezervne dijelove obratite se svom Wacker Neuson prodavaču ili posjetite mrežne stranice tvrtke Wacker Neuson: <http://www.wackerneuson.com/>.

Önemli : Yedek parça bilgileri için Wacker Neuson Bayinize bakın veya Wacker Neuson web sitesini ziyaret edin. <http://www.wackerneuson.com/>

重要 交換部品の情報については、ワッカーノイソンディーラーにお問い合わせ頂くか、ワッカーノイソンウェブサイト <http://www.wackerneuson.com/> をご覧ください。

重要 有关备件信息，请咨询您的威克诺森经销商或访问威克诺森网站：
<http://www.wackerneuson.com/>。

Important : Pentru informații referitoare la piesele de schimb, vă rugăm să vă adresați distribuitorului Wacker Neuson sau să vizitați site-ul web Wacker Neuson la adresa <http://www.wackerneuson.com/>.

Важно : За информация относно резервни части, моля, обърнете се към местния дилър на Wacker Neuson или посетете уебсайта на Wacker Neuson на адрес <http://www.wackerneuson.com/>.

Wacker Neuson Produktion GmbH & Co. KG, Preußenstraße 41, D-80809 München,

Tel.: +49-(0)89-3 54 02-0 Fax: +49 - (0)89-3 54 02-390

Wacker Neuson Production Americas LLC, N92W15000 Anthony Ave., Menomonee Falls, WI. 53051

Tel.: (262) 255-0500 Fax: (262) 255-0550 Tel.: (800) 770-0957

Wacker Neuson Limited - Room 1701-03 & 1717-20, 17/F, Tower 1, Grand Century Place, 193 Prince Edward Road West, Mongkok, Kowloon, Hongkong. Tel: (852) 3605 5360, Fax: (852) 2758 0032

