

TX 1000

REACH HIGHER AND LIFT MORE

THE COMPACT UTILITY LOADER, REDEFINED.

The all-new TX 1000 - a giant step forward in performance and versatility. This lightweight maneuverable machine packs unmatched strength and reach in a compact package for the ultimate working advantage. The 1,000 pound rated operating capacity makes the TX 1000 a powerful, compact alternative to larger skid steer loaders and other machines.

TX 1000 CONTROLS

New patent-pending control system exclusive to the Toro TX 1000 provides intuitive operation that's effortless for the operator, all day long.

- 1 Curl, dump or float the bucket while raising or lowering the loader arms with one hand using the joystick.
- 2 Grab the traction drive joystick for effortless, single-hand control.
- 3 Activate the auxiliary circuit control lever to power the attachments instantly.



TX 1000 FEATURES



UNMATCHED STRENGTH

Vertical lift loader arms allow the TX 1000 to lift and transport heavy loads with a category-leading rated operating capacity of 1,000 lbs.



MAXIMUM HEIGHT AND REACH

The 81" (206 cm) hinge pin height allows attachments to easily clear the side of 30-yard dumpsters or one-ton trucks.



HIGH DRIVE TRACK SYSTEM

Ideal for the demands of any jobsite to outperform on any surface, even sand or loose gravel.



COMPACT FOOTPRINT

The narrow model is just 33.7" (86 cm) wide and fits through standard 36" gates. At just 41" (104 cm) wide, the wide-track model is also easy to maneuver.

TX 1000

MEET THE FAMILY



DINGO TX 1000 SPECIFICATIONS

| | | DINGO TX 1000 NARROW TRACK 22327 | DINGO TX 1000 WIDE TRACK 22328 |
|------------|---|---|--------------------------------------|
| DIMENSIONS | A Wheelbase | 41" (10 cm) | |
| | B Ground Clearance | 6.0" (15 cm) | |
| | Overall Width | 33.7" (86 cm) | 41" (104 cm) |
| | C Overall Length | 100.7" (256 cm) w/bucket; 81.7" (208 cm) w/o bucket | |
| | D Overall Height | 53.2" (135 cm) | |
| | E Max Operating Height | 105" (267 cm) | |
| | F Hinge Pin Height | 81" (206 cm) | |
| | G Dump Height | 61" (155 cm) | |
| | H Dump Angle | 40-degrees | |
| | I Reach - Fully Raised | 24.5" (62 cm) | |
| | Ground Speed (F/R) | 4.7 mph (7.6 km/h)/ /4.7 mph (7.6 km/h) | |
| | Weight | 2,610 lbs (1184 kg) | 2,790 lbs (1266 kg) |
| | Tip Capacity | 2,857 lbs (1,296 kg) | 3,071 lbs (1,393 kg) |
| | Rated Operating Capacity (35% of Tip Capacity)* | 1,000 lbs (454 kg) | 1,075 lbs (488 kg) |
| | ENGINE Engine | Kubota® D1305 | |
| | Manufacturer's Gross HP Rating at RPM** | 24.9 HP (18.6 kW) @ 2600 rpm | |
| | Displacement | 77 cu. in. (1262cc) | |
| | Fuel Type | Diesel | |
| | Air Filter | Two-stage, heavy-duty, remote | |
| | Cooling System | Liquid Cooled | |
| | Fuel Tank | 11.5 gallons (44 liters) | |
| | Oil Capacity | 6.0 quarts (5.7 liters) | |
| | Loader Arms | Vertical | |
| | OPERATION Hydraulic Pressure | 3,000 PSI | |
| | Hydraulic Flow | Traction: 13.3 gpm (each pump); Auxiliary: 15.2 gpm | |
| | Reservoir Capacity | 10 gallons (57.5 liters) | |
| | TRACKS Tracks | Sprocket-drive, 6 road wheels per side | |
| | Traction | Dual hydrostatic pump | |
| | Track Length x Width | 127.6" x 5.9" (324 cm x 15 cm) | 127.6" x 9.5" (324 cm x 24 cm) |
| | Ground Pressure | 5.4 PSI | 3.6 PSI |

* Per ISO 14397-1
** Per SAE 1995

DINGO TX 427 & TX 525 SPECIFICATIONS

| | | TX 525 22323 | TX 525 WIDE 22324 | TX 427 22321 | TX 427 WIDE 22322 |
|---|---|---|-------------------------------|---|-------------------------------|
| A | Wheelbase | 31.2" (79 cm) | | 31.2" (79 cm) | |
| | B | Ground Clearance | | 4.6" (11.7 cm) | |
| | Overall Width | 33.7" (85.6 cm) | 41" (104 cm) | 33.7" (85.6 cm) | 41" (104 cm) |
| | C Overall Length | 92" (233.7 cm) w/bucket; 70.7" (180 cm) w/o bucket | | 92" (233.7 cm) w/bucket; 70.7" (180 cm) w/o bucket | |
| | D Overall Height | 46.1" (117.1 cm) | | 46.1" (117.1 cm) | |
| | E Max Operating Height | 90.1" (229 cm) | | 90.1" (229 cm) | |
| | F Hinge Pin Height | 65.8" (167.1 cm) | | 65.8" (167.1 cm) | |
| | G Dump Height | 46.1" (117.1 cm) | | 46.1" (117.1 cm) | |
| | H Dump Angle | 38-degrees | | 38-degrees | |
| | I Reach - Fully Raised | 21.8" (55.4 cm) | | 21.8" (55.4 cm) | |
| | Ground Speed (F/R) | 0-4.5 mph (0-7.2 km/h) / 0-2.0 mph (0-3.2 km/h) | | 0-4.5 mph (0-7.2 km/h) / 0-2.0 mph (0-3.2 km/h) | |
| | Weight | 1,904 lbs (864 kg) | 2,013 lbs (907 kg) | 1,882 lbs (854 kg) | 1,990 lbs (902 kg) |
| | Tip Capacity | 1,580 lbs. (717 kg) | | 1,530 lbs. (694 kg) | |
| | Rated Operating Capacity (35% of Tip Capacity)* | 553 lbs. (251 kg) | | 535 lbs. (243 kg) | |
| | Engine | Kubota D902 | | Kohler Command Pro Series CH 740 | |
| | Manufacturer's Gross HP Rating at RPM** | 23.3 HP (17.3 kW) @ 3400 rpm | | 25 HP (20.1 kW) @ 3600 rpm | |
| | Displacement | 55 cu. in. (901cc) | | 44 cu. in. (725cc) | |
| | Fuel Type | Diesel | | Gas | |
| | Air Filter | Two-stage, heavy-duty, remote | | Two-stage, heavy-duty, remote | |
| | Cooling System | Liquid Cooled | | Air Cooled | |
| | Fuel Tank | 6.0 gallons (23 liters) | | 6.0 gallons (23 liters) | |
| | Oil Capacity | 3.84 quarts (3.63 liters) 2.0 quarts (2.95 liters) | | 2.0 quarts (2.95 liters) | |
| | Loader Arms | Radial | | Radial | |
| | Hydraulic Pressure | 3,000 PSI | | 3,000 PSI | |
| | Hydraulic Flow | Traction: 16.9 gpm (each pump); Auxiliary: 13.8 gpm | | Traction: 16.9 gpm (each pump); Auxiliary: 11.4 gpm | |
| | Reservoir Capacity | 10.5 gallons (40 liters) | | 10.5 gallons (40 liters) | |
| | Tracks | Sprocket-drive, 10 road wheels per side | | Sprocket-drive, 10 road wheels per side | |
| | Traction | Dual hydrostatic pump | | Dual hydrostatic pump | |
| | Track Length | 96.6" x 5.9" (245 cm x 15 cm) | 96.6" x 9.5" (245 cm x 24 cm) | 96.6" x 5.9" (245 cm x 15 cm) | 96.6" x 9.5" (245 cm x 24 cm) |
| | Ground Pressure | 5.0 PSI | 3.5 PSI | 5.0 PSI | 3.5 PSI |

* Per ISO 14397-1
** Per SAE 1995

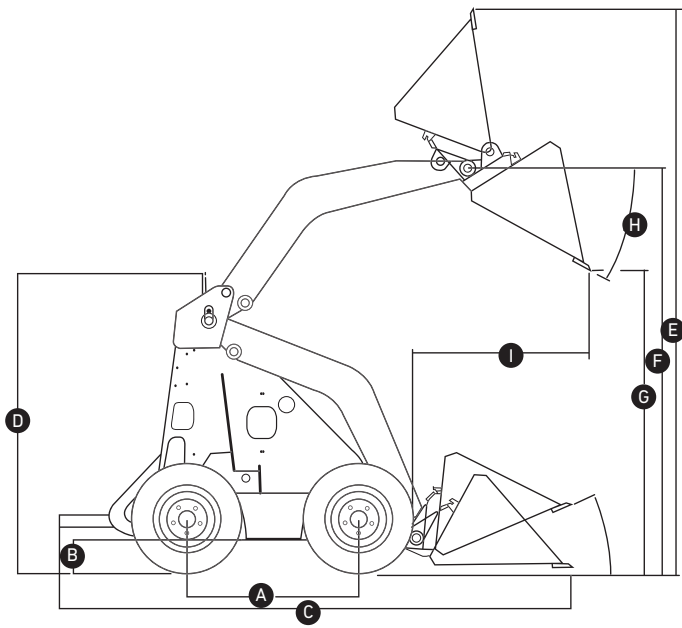
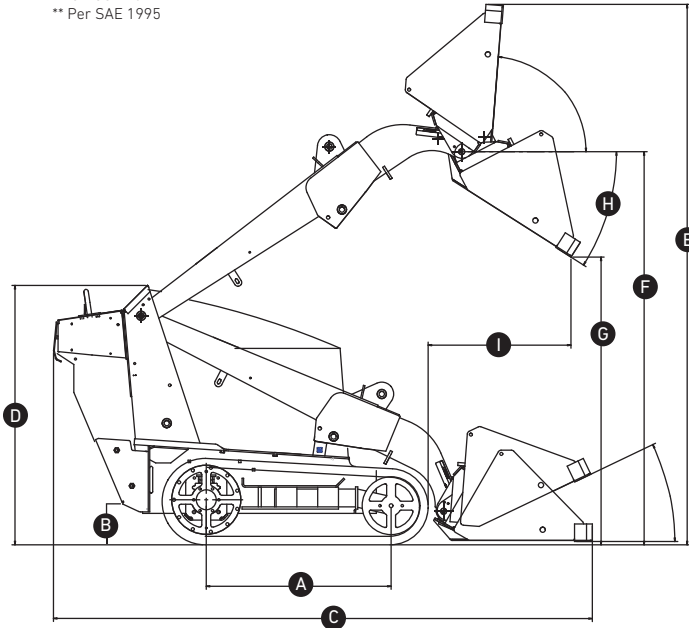

DINGO 220, 323 & 320-D SPECIFICATIONS

| | | DINGO 220 22317 | DINGO 323 22318 | DINGO 320-D 22337CP |
|---|---|--|-------------------------------|---|
| A | Wheelbase | 28" (71 cm) | | |
| | B | Ground Clearance | | |
| | Overall Width | 40.5" (103 cm) standard tires; 35" (90 cm) narrow tires | | |
| | C Overall Length | 82.2" (208.8 cm) w/bucket; 62" (157.5 cm) w/o bucket | | |
| | D Overall Height | 48.7" (123.7 cm) | | |
| | E Max Operating Height | 91.2" (231.6 cm) | | |
| | F Hinge Pin Height | 66" (167.6 cm) | | |
| | G Dump Height | 47" (119 cm) | | |
| | H Dump Angle | 34-degrees | | |
| | I Reach – Fully Raised | 28" (71.1 cm) | | |
| | Ground Speed (F/R) | 0-3.7 mph (0-6 km/h) / 0-3.7 mph (0-6 km/h) | | 0-3.0 mph (0-4.8 km/h) / 0-3.0 mph (0-4.8 km/h) |
| | Weight | 1,430 lbs (649 kg) | 1,567 lbs (711 kg) | 1,722 lbs (781 kg) |
| | Tip Capacity | 1,030 lbs (467 kg) | | 1,048 lbs (146 kg) |
| | Rated Operating Capacity (50% of Tip Capacity)* | 515 lbs. (234 kg) | | 524 lbs. (238 kg) |
| | Engine | Kohler® Command Series CH20 | Kohler® Command Series CH23 | Kubota D722 |
| | Manufacturer's Gross HP Rating at RPM* | 20 HP (14.9 kW) @ 3600 rpm | 23 HP (17.2 kW) @ 3600 rpm | 20 HP (14.9 kW) @ 3600 rpm |
| | Displacement | 38.1 cu. in. (624 cc) | 41 cu. in. (674cc) | 43.88 cu. in. (719 cc) |
| | Fuel Type | Gas | | Diesel |
| | Air Filter | High-capacity, paper type w/pre-cleaner | Two-stage, heavy-duty, remote | |
| | Cooling System | Air Cooled | | Liquid Cooled |
| | Fuel Tank | 5.6 gallon (21 liter) | 11.2 gallon (42.4 liter) | 4 gallon (15 liter) |
| | Oil Capacity | 2 quarts (1.9 liter) | | 3.4 quarts (3.2 liter) |
| | Loader Arms | Radial | | |
| | Hydraulic Pressure | 3,250 PSI | | |
| | Hydraulic Flow | 10.8 gpm high-flow hydraulic circuit, 4 gpm low-flow hydraulic circuit | | |
| | Reservoir Capacity | 14.8 gallons (56 liter) | 17 gallons (64 liter) | 14.8 gallons (56 liter) |

* Per ISO 14397-1
** Per SAE 1995

DIMENSIONS

- A Wheelbase
- B Ground Clearance
- C Overall Length
- D Overall Height
- E Maximum Operating Height
- F Hinge Pin Height
- G Dump Height
- H Dump Angle
- I Reach