



KTR 30 TURF ROLLER

OPERATOR'S MANUAL & PARTS LIST



KESMAC Inc

23324 Woodbine Avenue, Keswick Ontario Canada L4P 3E9
Tel (905) 476-6222 Fax (905)-6744 Web Site www.Kesmac.com
info@kesmac.com



STATEMENT OF LIMITED WARRANTY

Kesmac and Brouwer Turf warrants its full line of equipment to be free from defects in material and factory workmanship for a period of 12 months. This warranty begins on the date of sale or use of the equipment to the original purchaser. This statement does not extend or limit engine, tractor or component warranties in which the engine, tractor or component manufacturers may carry extended time periods up to 24 months. Engine, tractor or component warranty claims will be subject to the engine, tractor or components manufacturer's approval.

Replacement Parts carry a 90 day replacement warranty and are reimbursed to the dealer. All electrical and hydraulic parts are limited by this policy and will only be covered upon approval by the service department after inspection of the part. The installation and removal of a part will automatically place that part under the replacement parts warranty.

This warranty is limited exclusively to equipment or accessories manufactured or supplied by **Kesmac and Brouwer Turf** and are subject to the inspection and analysis by the company to conclusively identify the nature and cause of failure.

PRODUCT REGISTRATION FORM must be completely filled out, signed by the customer at the original date of installation, and returned to **Kesmac and Brouwer Turf** before any claims will be considered.

Kesmac and Brouwer Turf reserves the right to incorporate improvements in material and design of its products without notice and is not obligated to make the same improvements to equipment previously manufactured.

Kesmac and Brouwer Turf is not obliged under any warranty policy different from the Kesmac Brouwer Turf warranty policy as published above.

KESMAC AND BROUWER TURF RESPONSIBILITIES

Kesmac and Brouwer Turf's obligation under the terms of this warranty is limited to the repair, replacement or credit, at its option, of the equipment, parts or supply items that conform to its warranty.

Kesmac and Brouwer Turf will pay for the parts and the cost of surface transportation for the parts that conform to this warranty.

DEALER'S RESPONSIBILITIES

1. Only factory-trained service or approved personnel will be permitted to perform warranty service on **Kesmac and Brouwer Turf** equipment.
2. All major warranty claims exceeding \$650.00 (in total including parts and labour) must be authorized by **Kesmac and Brouwer Turf** before work is performed.
3. All replacement parts used in warranty situations must be furnished by **Kesmac and Brouwer Turf** or approved by **Kesmac and Brouwer Turf** personnel. The use of non-recommended oil could nullify warranty.

OWNERS RESPONSIBILITIES

The owner is obligated to operate and maintain the equipment in accordance with the recommendations published by **Kesmac and Brouwer Turf** in the owners/operators manual for the unit. The owner is responsible for the costs associated with such maintenance and operating adjustments that may be required on a regularly scheduled basis. Where applicable the owner is responsible for transportation to and from the dealership or service calls made by the dealer.

CONDITIONS THAT VOID WARRANTY

This warranty shall not apply to equipment which:

- 1. Has had repairs or modifications not authorized by **Kesmac and Brouwer Turf**.
- 2. Has been subject to abuse, improper maintenance, or improper application.
- 3. Has been modified from original equipment specifications.

WARRANTY EXCEPTIONS

This warranty does not apply to the following items:

- 1. Wear items including blades, cutting edges, cutting arms, spark plugs, belts, filters, bearings, sprockets, chains, tires, light bulbs, lubricants and fluids etc. Cost of normal maintenance including replacement of service items.
- 2. Damages to engine/drive systems caused by lack of/ or improper lubricants and/ or fluids.
- 3. Damages arising from accident, misuse or neglect.
- 4. Damages to engine/drive systems caused by improper operation and/ or maintenance.
- 5. **Kesmac and Brouwer Turf** will not be liable for any incidental or consequential damage or injuries, including but not limited to loss of profits, loss of crops, rental of substitute equipment, or other commercial loss or for damage to the equipment in which the Company Product is installed.

FREIGHT CARRIER DAMAGE

Claims for equipment damaged in transit should be referred to the freight carrier. Visible damage should be reported immediately and concealed damage as soon as possible, in accordance with freight carrier regulations.

**KESMAC
KTR 30 – TURF ROLLER**

CONTENTS

SECTION 1 – Operators Manual

General Safety	1
Safety Precautions	2
Decals	3
Operating Instructions	
Front & Rear Rollers	4
Engine	5
Controls	5
Engine Speed Control	6
Maintenance	
Engine	6
Forward / Reverse Adjustment	7
Drive Chain	8
Operating Handle Storage	9
Lubrication	10
Specifications	11

SECTION 2 – Parts List

Frame & Rollers Assembly	1
Drive Sprockets & Chains	3
Controls	5
Engine & Transmission	7
Power Unit Protection Cage	9
Dead-Man Switch Assembly	9
“Ride On” Accessory	11
Eaton Hydrostat Transmission	14

Section 1 – Operators Manual

GENERAL SAFETY



INDICATES AN IMMEDIATE HAZARDOUS SITUATION WHICH IF NOT CORRECTED OR AVOIDED, **WILL** RESULT IN DEATH OR INJURY.



INDICATES THE POTENTIAL HAZARDOUS SITUATION WHICH **COULD** RESULT IN DEATH OR SERIOUS INJURY IF NOT AVOIDED,



INDICATES A POTENTIALLY HAZARDOUS SITUATION WHICH **MAY** RESULT IN A MINOR/MODERATE INJURY.



SAFETY ALERT SYMBOL

Hazards are identified by this symbol
Followed by the signal words
“DANGER, WARNING or CAUTION”.

Always follow safe operating and maintenance practices to ensure your own safety and also that of others.

The warning and safety signs are prominently displayed and strategically located on the machine. Make sure that the decals are always in good condition and easily readable. The decals are illustrated on the following pages.

It is important that you familiarize yourself with these safety signs.

Do not operate this machine if drugs, alcohol or medication are being used which can affect alertness or co-ordination.

Seek professional advice before operating the machine if in doubt about side effects from any medication being taken that may put your safety at risk.



WARNING

- **DO NOT RUN THE ENGINE AT EXCESSIVELY HIGH SPEED.**
- **DO NOT OPERATE THE MACHINE IF THE CHAIN AND THE ENGINE GUARDS ARE NOT SECURED IN PLACE OR ARE DAMAGED.**
- **WHEN OPERATING THE MACHINE WHILE WALKING BESIDE IT, KEEP YOUR FEET CLEAR OF THE ROLLERS.**
- **TO MAINTAIN CONTROL OF THE MACHINE, USE ONLY LOWEST SPEED WHILE WALKING ALONG SIDE THE MACHINE.**
- **WHEN OPERATING ACROSS THE SIDE OF A SLOPE, EXERCISE CAUTION AND ALWAYS WALK ON THE UP-HILL SIDE OF THE TURF ROLLER.
DO NOT OPERATE ON SLOPES GREATER THAN 20° AS THE MACHINE MAY TIP CAUSING PERSONAL INJURY AND DAMAGE TO THE MACHINE.**
- **WHEN PARKING AND ALSO TO PREVENT ACCIDENTAL MOVEMENT OF THE MACHINE, SWITCH THE ENGINE ‘OFF’.**

KESMAC TURF ROLLERS

Safety Precautions.

IMPORTANT

The Owner and Operator, must assume responsibility for the safe operation of the machine, their own safety, and the safety of others, by reading, understanding, and following, all of the safety instructions and operating procedures as outlined in the machines Operator's Manual. Failure of the Owner or Operator to adhere to the recommended safety instructions and operating procedures, indemnifies Kesmac Inc. against any claims that may arise, due to accidents resulting in personal injury or property damage.

It is not possible to list all situations that may affect the safety of the machine or the operator(s), and therefore Kesmac Inc. cannot list all precautions, and identify all potential hazards, that may possibly prevent accidents.

IF YOU DO NOT UNDER STANDASK

BE A QUALIFIED OPERATOR BY:

- Reading and obeying the written instructions in this manual and the safety decals on the machine.
- Receiving operational training on the Turf Roller.
- Asking your supervisor or equipment dealer to explain things you do not understand.
- Explain the written instructions in the operator manual and safety decals to users/operators who cannot read or understand them.



WARNING

Kesmac Turf Rollers are designed for safe efficient operation and must not be used for any purpose other than that for which they are designed.

Prior to being shipped from the manufacturer the machines are inspected to insure that all guards, shields and warning/operating decals are correctly positioned and secure.

Before operating the machine the operator must check that all of the above items are correctly located.

Machines must not be used if any guards, shields or warning/operating decals are damaged or missing.

DURING MAINTENANCE

- Use only genuine Kesmac replacement parts. Parts that are not supplied by Kesmac may not meet Kesmac specifications or standards of manufacture and may void warranty. The use of non-approved parts may result in component failure and possibly cause an accident and injury to the operator or others.



CAUTION

Allow sufficient time for the engine to cool down before doing any service work.

Failure to observe this precaution may result in burns from hot exhaust components.

NOTE

Reference to RIGHT or LEFT are to be interpreted as viewed from the driver/operators position looking forward.

IMPORTANT

Check oil level daily.
Top up to correct level
when COLD.

**DO NOT FILL PAST
THE LEVEL MARK.**

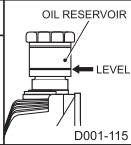
**IMPORTANT**

**USE SYNTHETIC SAE
5W40 ONLY**

D001-068

IMPORTANT

The Hydrostatic Transmission
housing must be kept clean and
free of oil and dust to ensure
proper cooling.

D001-146

CAUTION**HOT EXHAUST**

To avoid injury keep
clear of exhaust pipes
and muffler.

D001-053

WARNING

CRUSHING HAZARD
Stay clear of moving parts

D001-054



Current from Serial No. 341



Non Current up to
Serial No. 341

CAUTION

**TO PREVENT TIPPING
WHEN ON SLOPES
STOP THE UNIT
BEFORE CHANGING
FORWARD / REVERSE
DIRECTION. OPERATE
CONTROLS SLOWLY
AND SMOOTHLY.**

D001-073

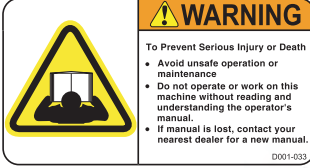

D001-033

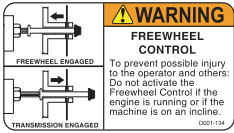

D001-134

kesmac**kesmac**

D001-054

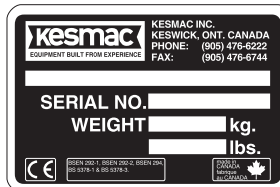
**IMPORTANT**

Allow air to vent from
drum when filling.

D001-133

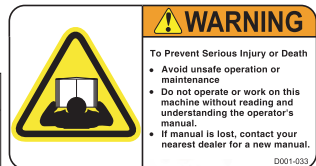

D001-033

kesmac

D001-F17



D001-S15



D001-054



OPERATING INSTRUCTIONS

FRONT AND REAR ROLERS

Fig. 1

The large front roller has two fill/drain plugs. The roller can be filled with water to the level needed for any required roller weight. The fill/drain plug threads are the same as standard garden hose end fittings. Water can be drained out for transporting the machine.

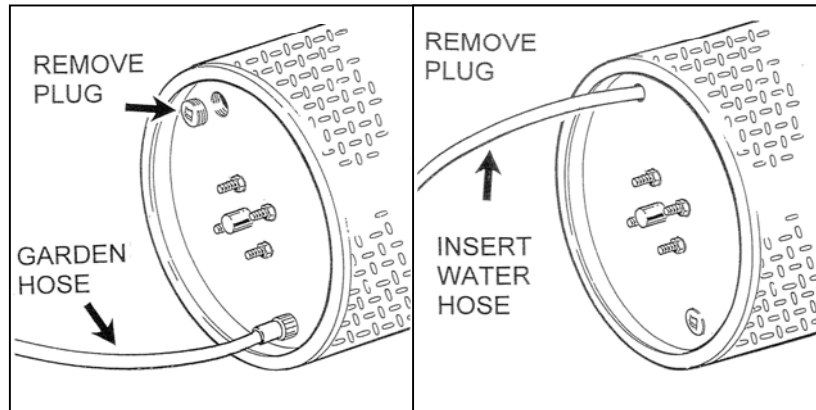

Fig. 1

Fig. 2

The small rear roller has one fill/drain plug. It is recommended that before operating the Turf Roller the rear roller should be filled permanently with sand. This improves the stability of the machine, particularly when operating on a down slope.

To fill the rear roller with sand the following procedure is recommended:

- Lift the Control Handle up until the rear roller is just clear of the ground.
- Place a suitable support under the Control Handle.
- Remove the 7/16 unc x 1 ½ bolts, washers, and locknuts securing the roller bearings and pull the roller clear of the frame.
- Stand the roller 'on-end'. Remove the plug and with a funnel fill the roller with sand. Replace the fill/drain plug.
- Refit the roller assembly.

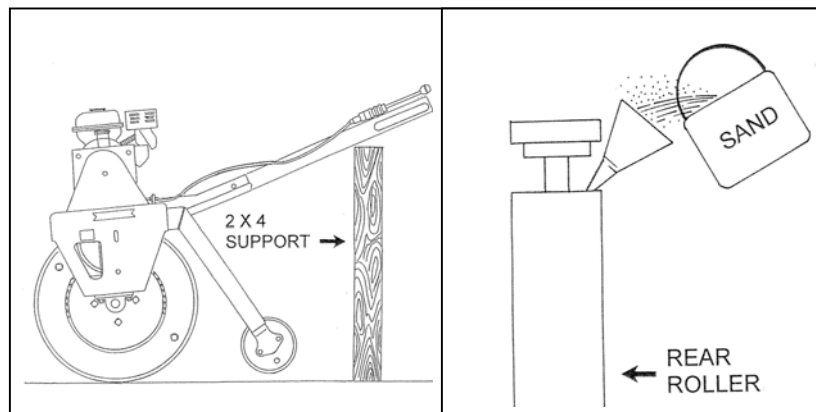

Fig. 2



CAUTION

When operating the machine on a down slope do not stop the machine abruptly. A sudden stop may cause the machine to tip forward.
DO NOT OPERATE UP/DOWN OR ACROSS SLOPES GREATER THAN 20 DEGREES.

OPERATING INSTRUCTIONS

ENGINE

The Kesmac KTR 30 Turf Roller is fitted with a Honda GX160 Engine. The owner's manual for the engine is supplied with the machine.

It is important to follow the operating and service instructions contained in the manual.

CONTROLS

Fig. 3

The hand control lever for the hydrostatic transmission is located on the Turf Roller Handle.

Up to Serial No. 341 - Move the lever to the left for 'FORWARD' and move to the right for 'REVERSE'.

From Serial No. 342 - Move the lever to the right for 'FORWARD' and move to the left for 'REVERSE'.

The transmission is fitted with a "FREE-WHEEL" control. This allows easy movement of the machine when the engine is not running. The control is located on the front of the transmission mounting support, between the fan shroud and chain guard.

Up to Serial No. 450 - To put the transmission into "FREE-WHEEL", release the Wing Nut and turn the Control Knob clockwise - 'fully inward'. Reverse the procedure for 'DRIVE' mode.

From Serial No. 451 - To put the transmission into "FREE WHEEL", remove the Hitch Pin from the 'inner hole' and press the Control Pin - 'fully inward', insert the Hitch Pin into the 'outer hole'. Reverse the procedure for 'DRIVE' mode.



WARNING

Do not activate the Free-Wheel control if the engine is running or the machine is stopped on an incline.

To prevent sudden movement of the machine, which may cause injury to the operator or others, operate the Control Lever slowly and smoothly from NEUTRAL to FORWARD and REVERSE.

When the hand control lever is in the NEUTRAL (centered) position, the engine is DISENGAGED from the transmission.

When the engine is stopped and the hand control lever is in the NEUTRAL (centered) position, the transmission is locked.

The engine 'ON-OFF' switch has been relocated from the engine to the handle, for operator convenience and safety.

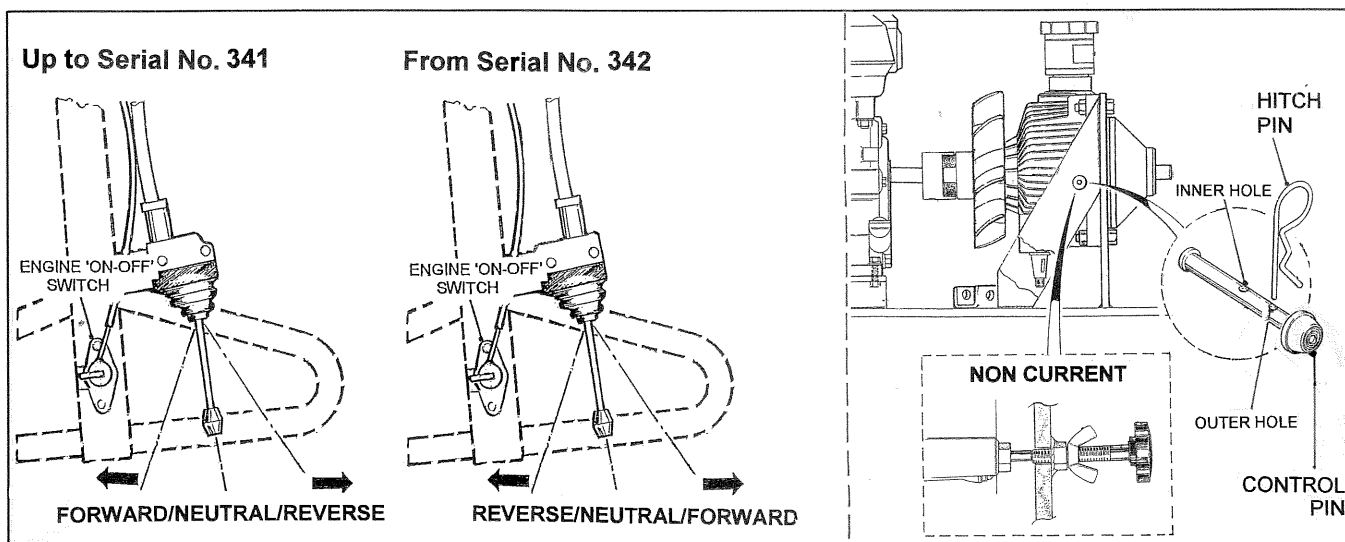

Fig. 3

OPERATING INSTRUCTIONS

ENGINE SPEED CONTROL

Refer to the Honda Engine Owners manual for the instructions on setting the engine speed.
Set the engine speed control to give two-thirds throttle opening.

IMPORTANT

Do not run the engine at low speed as this may cause damage to the transmission due to inadequate cooling air flow.



WARNING

When the engine is running and the hand control lever is in the NEUTRAL (centered) position, the transmission is in "FREE-WHEEL" mode and if the machine is left unattended it can move/roll and cause personal injury or machine damage.

MAINTENANCE

ENGINE

Refer to the Honda Engine Owners Manual for recommended engine maintenance procedures,

TRANSMISSION Fig. 4

Check the oil level in the transmission oil reservoir
DAILY. The reservoir is marked 'correct level' when COLD. **DO NOT OVERFILL**.

IMPORTANT

USE SYNTHETIC SAE 5W40
ONLY. PETRO-CANADA*
DURON SYNTHETIC OR
EQUIVALENT.

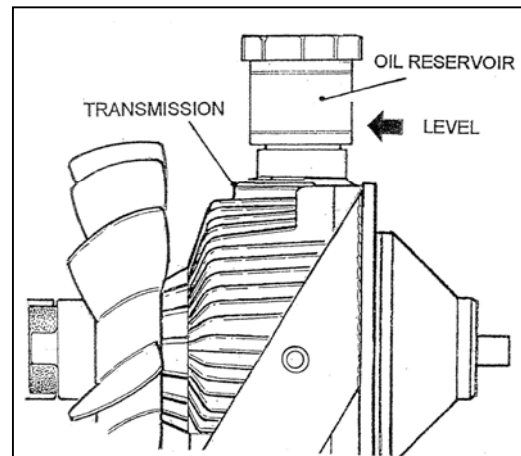

Fig.4

*FOR CLOSEST PETRO-CANADA DEALER
CALL – CANADA – 1 800 268-5850
USA - 1 800 284-4572
U.K. - +44(0) 2476-247294

IMPORTANT

If the Roller is inadvertently upset, e.g. tips forward, ensure that the oil levels are checked in the Transmission and Engine and topped up if necessary. Failure to do so can cause serious damage to both units.

MAINTENANCE

FORWARD-NEUTRAL-REVERSE ADJUSTMENT

It is important that the F – N – R Control Lever and the transmission Lever Arm are adjusted to give the correct forward and reverse speeds. When replacing parts or servicing the unit, adjust as follows.

- Remove the Cooling Fan Shroud.
- Remove the Cable End Clevis from the Transmission Lever Arm.
- Release the four nuts on the Adjusting Bolts and screw in the bolts fully.
- Adjust the Cable End Clevis to allow the Clevis Pin to fit through the Lever Arm but NOT moving the Lever Arm from it's neutral position. (From Serial No. 233 a bushing is fitted in the lever arm. Check that it is in place – if applicable.)
- Refit the Split Pin.
- Move the Control Lever to the 'FORWARD' position until the transmission Lever Arm hits its internal stop. Hold the Control Lever in this position and unscrew the 'FORWARD' Adjusting Bolt until it touches the transmission Lever Arm. Tighten the Locking nuts.
- Repeat the above adjustment for the 'REVERSE' setting except that the reverse Adjusting Bolt should be unscrewed a further $\frac{1}{4}$ inch after touching the Lever Arm, This reduces the maximum reverse speed.

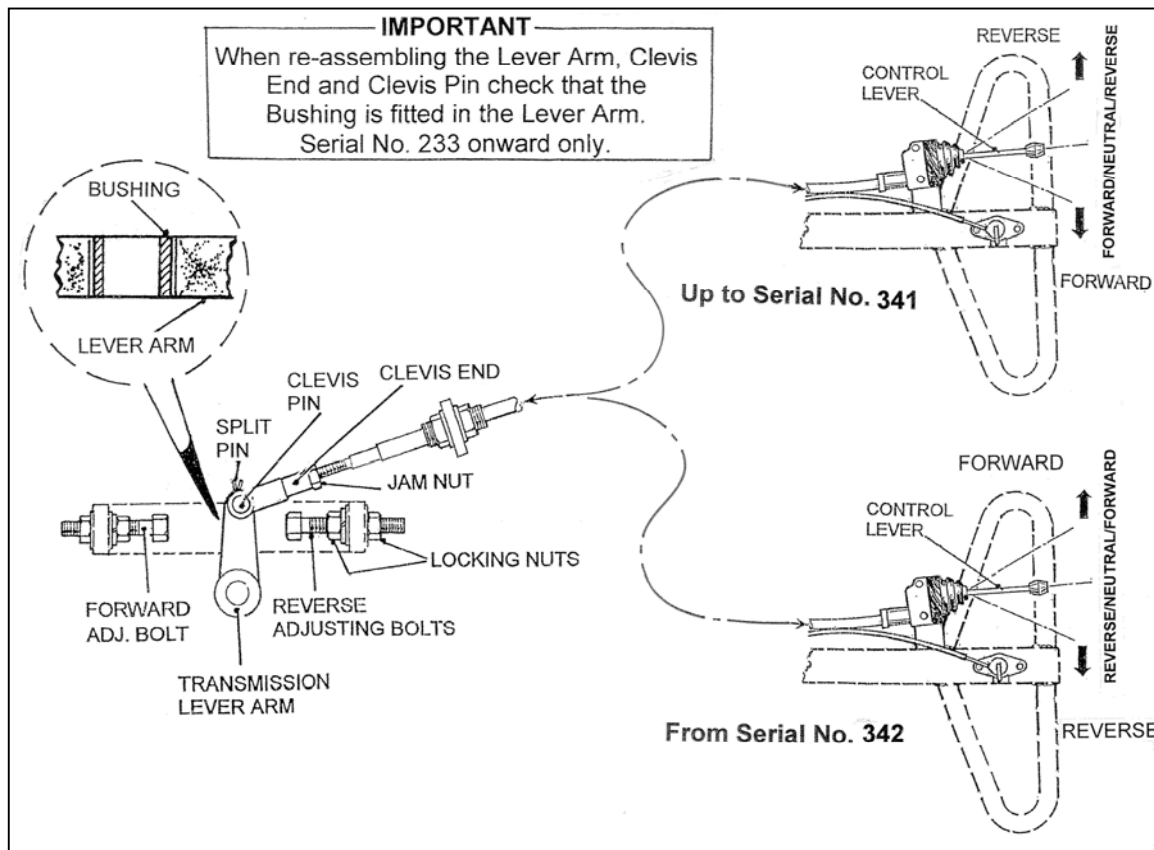

Fig.5

MAINTENANCE

DRIVE CHAINS, REMOVE / REPLACE / ADJUST

FIG. 6

To adjust the Roller Drive Chain 1:

- Loosen the Bolt 2 and Nut 3, this allows intermediate Spindle 4 to slide up or down.
- Position a suitable bar/tool in the frame and against the bottom of the Intermediate Sprocket 5.
- Apply sufficient weight on the bar/tool in the direction of arrow 'A', to tension the Roller Drive Chain 1.
- Tighten the Bolt 2 and Nut 3.

To adjust the Intermediate Dive Chain 6:

- Back-off the bolt in the Idler Adjusting Sprocket 7.
- Apply pressure in direction of arrow 'B' to tension the Intermediate Chain 6.
- Tighten the bolt in the Idler Adjusting Sprocket 7.

IMPORTANT

DO NOT OVER TENSION THE DRIVE CHAINS. THEY MUST NOT BE BAR TIGHT. THIS WILL CAUSE PREMATURE CHAIN WEAR AND BEARING FAILURE. LUBRICATE THE CHAINS WITH OIL. DO NOT USE GREASE.

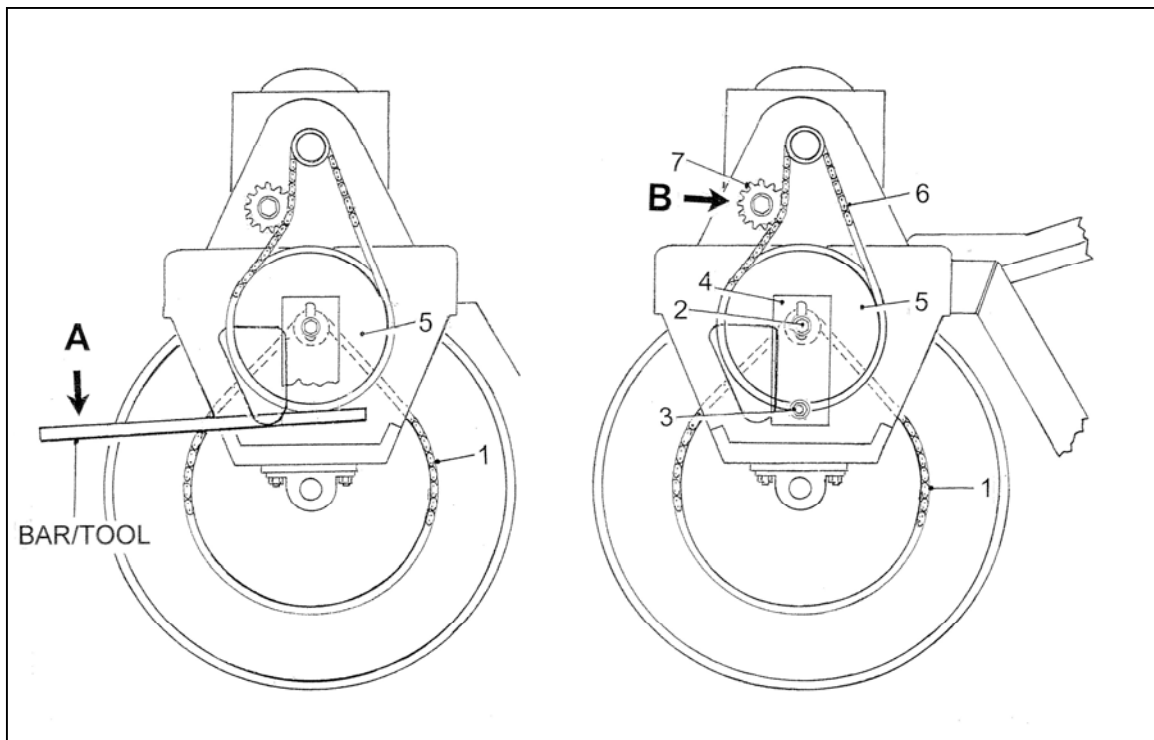

Fig.6

OPERATING HANDLE STORED POSITION

IMPORTANT

When it is required to fold up the handle, for storage or transport, remove the LOWER BOLT to allow the handle to pivot over-center and remain in position.

If the unit is to be transported long distances or over bumpy surfaces a shock cord from the handle to the frame will provide extra security.

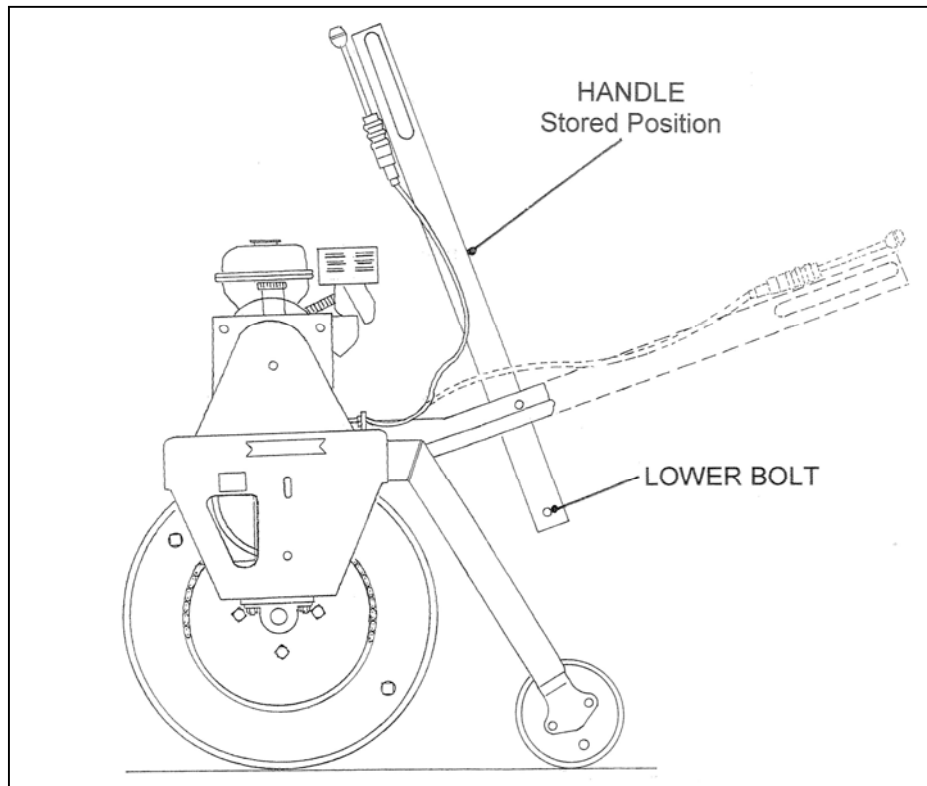

Fig.7

LUBRICATION

Fig.8

1. TRANSMISSION: SYNTHETIC SAE 5W40. Check oil level daily.
If the Roller is used daily it is recommended to change the transmission oil every 2 months. Occasional service would allow that period to be extended accordingly, but not to exceed 12 months. To change the oil:

- Remove the Fan Shroud.
- Remove the transmission drain plug and the fill plug.
- Drain the oil into a suitable container.
- Replace the drain plug
- Refill with 20 fl. oz. (600ml.) of the correct oil to the bottom of the fill plug hole.
- Replace the fill plug.
- Top up the reservoir to the correct level
- Replace the Fan Shroud.

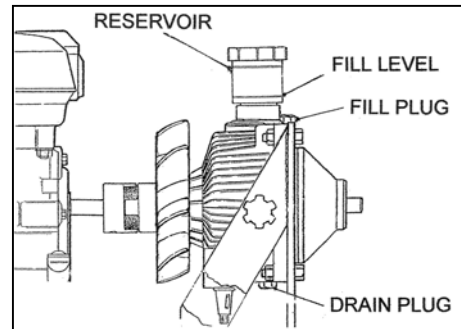

Fig.8

Fig.9

2. ENGINE: Refer to the Honda Engine Owners Manual. Supplied with the machine
3. CHAINS: SAE 30 OIL. Daily. (DO Not Use Grease On The Chains.)
4. FRONT & REAR ROLLER BEARINGS: Grease Monthly

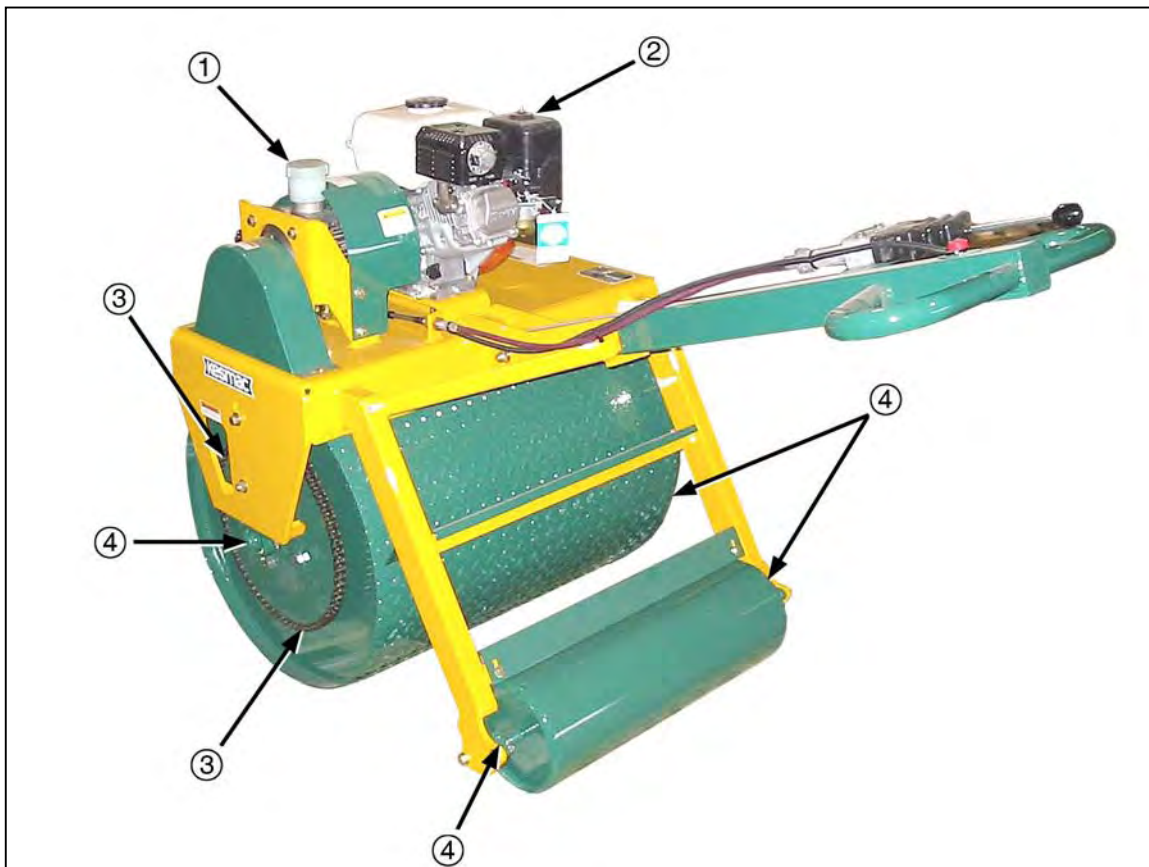

Fig.9

Regular washing and cleaning of your Kesmac Turf Roller will be a benefit in operation, maintenance and reliability.

KESMAC KTR 30 TURF ROLLER

SPECIFICATIONS

LENGTH - Operating.....63.0in.(1600mm)
- Stored.....37.5in.(952mm)

WIDTH 36.0in.(914mm)

HEIGHT - Operating (No Roll Cage)..... 40.5in.(1029mm)
- Operating (With Roll Cage)..... 58.75 in.(1492mm)
- Stored..... 57.0in.(1448mm)

FRONT ROLLER – Diameter..... 24.0in.(610mm)
- Width.....30.0in.(762mm)

REAR ROLLER - Diameter 8.0in.(203 mm)
- Width30.0in.(762mm)

* **WEIGHT** - 1/8 in. Steel Drum. Dry. 530.lbs.(240kg)
- 3/16 in. Steel Drum. Dry. 551.lbs.(250kg)

* Drum full with water, add 400 lbs. (181kg)
Rear roller full with sand, add 80 lbs. (36kg)

ENGINE.....HONDA GX160 5.5 HP

TRANSMISSION.....EATON – MODEL 7
HYDROSTATIC



SECTION 2

KTR 30 TURF ROLLER

PARTS LIST

IMPORTANT

When ordering parts for this machine the serial number, model number and part color must be quoted.



 EQUIPMENT BUILT FROM EXPERIENCE	KESMAC INC. KESWICK, ONT. CANADA PHONE: (905) 476-6222 FAX: (905) 476-6744	
	SERIAL NO. <input type="text"/>	
WEIGHT <input type="text"/> kg.		
<input type="text"/> lbs.		
	BS EN 292-1, BS EN 292-2, BS EN 294, BS 5378-1 & BS 5378-3	 MADE IN CANADA IMPORTED BY KESMAC INC.

NOTE

REPLACEMENT PARTS FOR THE HONDA GX160 ENGINE
MUST BE ORDERED FROM THE HONDA DEALER IN YOUR AREA.
Go to: www.honda.com This is the corporate web site from which Honda engines/power
equipment dealers can be located.
Eg. Europe: www.honda-engines-eu.com
Australia: www.hondapowerequipment.com.au

FRAME & ROLLERS ASSEMBLY

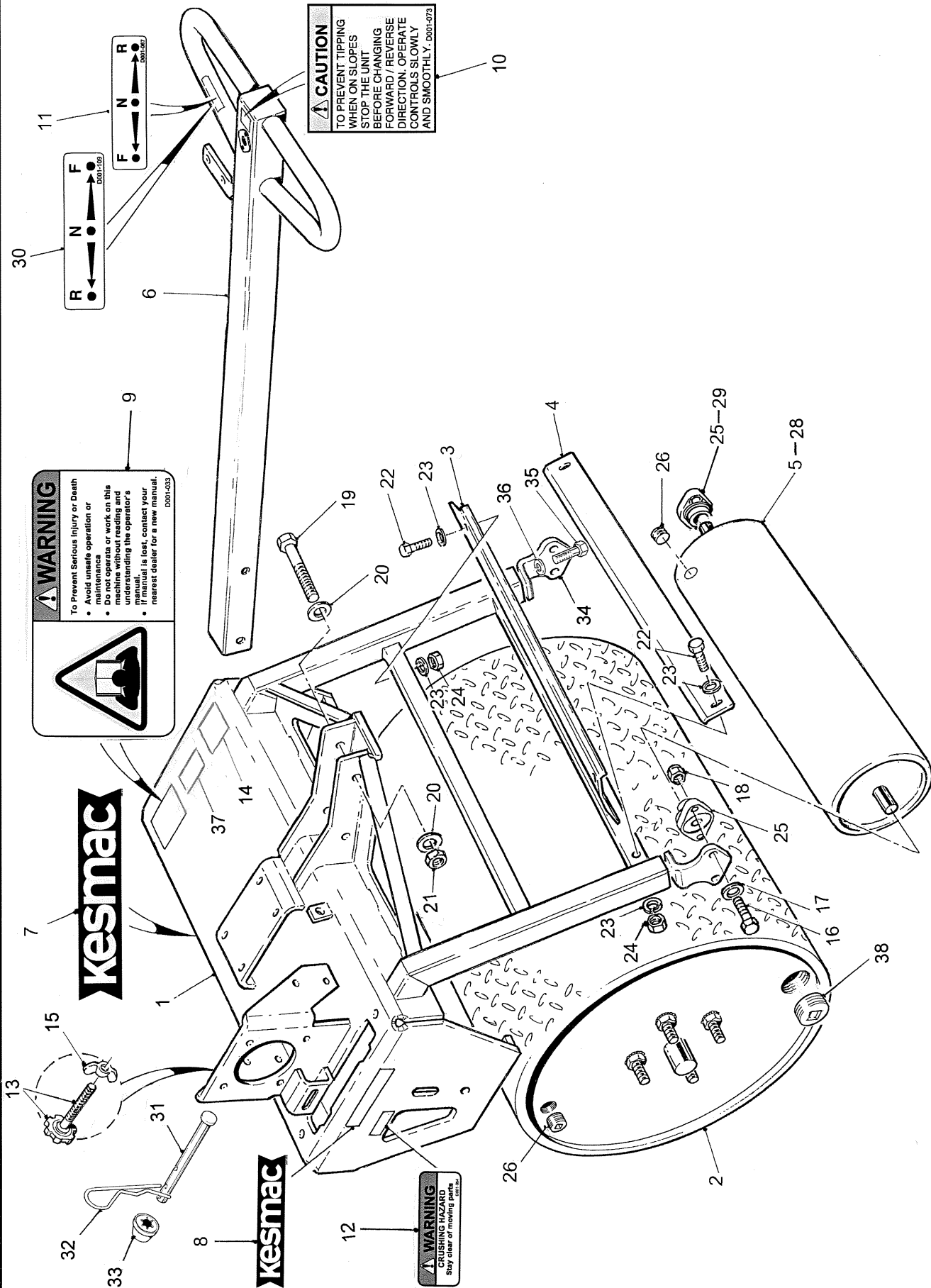

ITEM NO.	PART NO.	DESCRIPTION	QTY
<p style="text-align: center;">KTR 30 TURF ROLLER FRAME AND ROLLERS ASSEMBLY</p>			
1	TR30033	Roller Housing	1
2	TR30010	Roller - 24 in. Dia. (Traction)	1
	TR30180	Roller - 24 in. Dia. (Smooth)	1
	TR30183	Roller - 24 in. Dia. (Traction. Heavy Duty)	1
3	TR10055	Scraper - 24in. Roller	1
4	TR10056	Scraper - 8in. Roller	1
5	TR30012	Roller - 8in. Dia. Non Current to Serial No. 294. (except Serial No. 293)	1
6	TR30083	Handle	1
7	D001-014	Decal - Kesmac	1
8	D001-013	Decal - Kesmac 6in.	2
9	D001-033	Decal - "Warning to Prevent Serious..."	1
10	D001-073	Decal - "Caution to Prevent tipping..."	1
11	D001-067	Decal - "F - N - R" Non Current up to Serial No. 341	1
12	D001-054	Decal - "Warning Crushing Hazard..."	2
13	TR50194	Knob Thumbscrew Adjuster Assembly. Non Current up to Serial No. 450	1
14	D001-112	Serial No. Plate	1
15	F420601	Wing Nut. Non Current up to Serial No. 450	1
16	F040714	Bolt 7/16 unc x 1 1/2 Gr.8 (For Item 25 - KB32012 Flange Bearing.)	4
	F041020	Bolt 5/8 unc x 2 Gr. 8 (For Item 29 - KB32016 Flange Bearing.)	4
17	F320700	Washer 7/16 (For Item 25 - KB32012 Flange Bearing.)	4
	F330908	Washer 9/16 (For Item 29 - KB32016 Flange Bearing.)	4
18	F210700	Locknut 7/16 unc (For Item 25 - KB32012 Flange Bearing.)	4
	F211000	Locknut 5/8 unc (For Item 29 - KB32016 Flange Bearing.)	4
19	F040840	Bolt 1/2 unc x 4 Gr.8	2
20	F320700	Washer 7/16	4
21	F210800	Locknut 1/2 unc	2
22	F040510	Bolt 5/16 unc x 1 Gr.8	4
23	F320400	Washer 1/4	8
24	F210500	Locknut 5/16 unc	4
25	KB32012	Flange Bearing. Non Current to Serial No. 294. (except Serial No. 293)	2
26	KH00015	Pipe Plug 3/4 NPT. Sq. Hd.	2
27	D001-043	Reflector Tape - Red & Silver. (Not Illustrated)	1
28	TR30237	Roller - 8in. Dia. Current from Serial No. 293. (except Serial No. 294)	1
29	KB32016	Flange Bearing. Current from Serial No. 293. (except Serial No. 294)	2
30	D001-109	Decal - "R - N - F" Current from Serial No. 342	1
31	TR10320	Pin. Free Wheeling. Current from Serial No. 451	1
32	F940224	Hitch Pin Clip. Current from Serial No. 451	1
33	KX50105	Push Cap Nut. Current from Serial No. 451	1
34	TR10072	Bearing Mounting Bracket - Current from Serial No. 467	2
35	F040610	Bolt 3/8 unc x 1 Gr.8	4
36	F310600	Lockwasher 3/8	4
37	D001-133	Decal - "Important Allow air to vent..."	1
38	KH00026	Pipe Plug 2 NPT. Recessed Sq. Hd.	1
<p style="text-align: center;">NOTE</p> <div style="border: 1px solid black; padding: 5px;"> <p>TR30010 - Not Available. Replaced by Assembly TR50408. TR30180 - Not Available. Replaced by Assembly TR50409. TR30183 - Not Available. Replaced by Assembly TR50410.</p> </div>			

DRIVE SPROCKETS & CHAINS

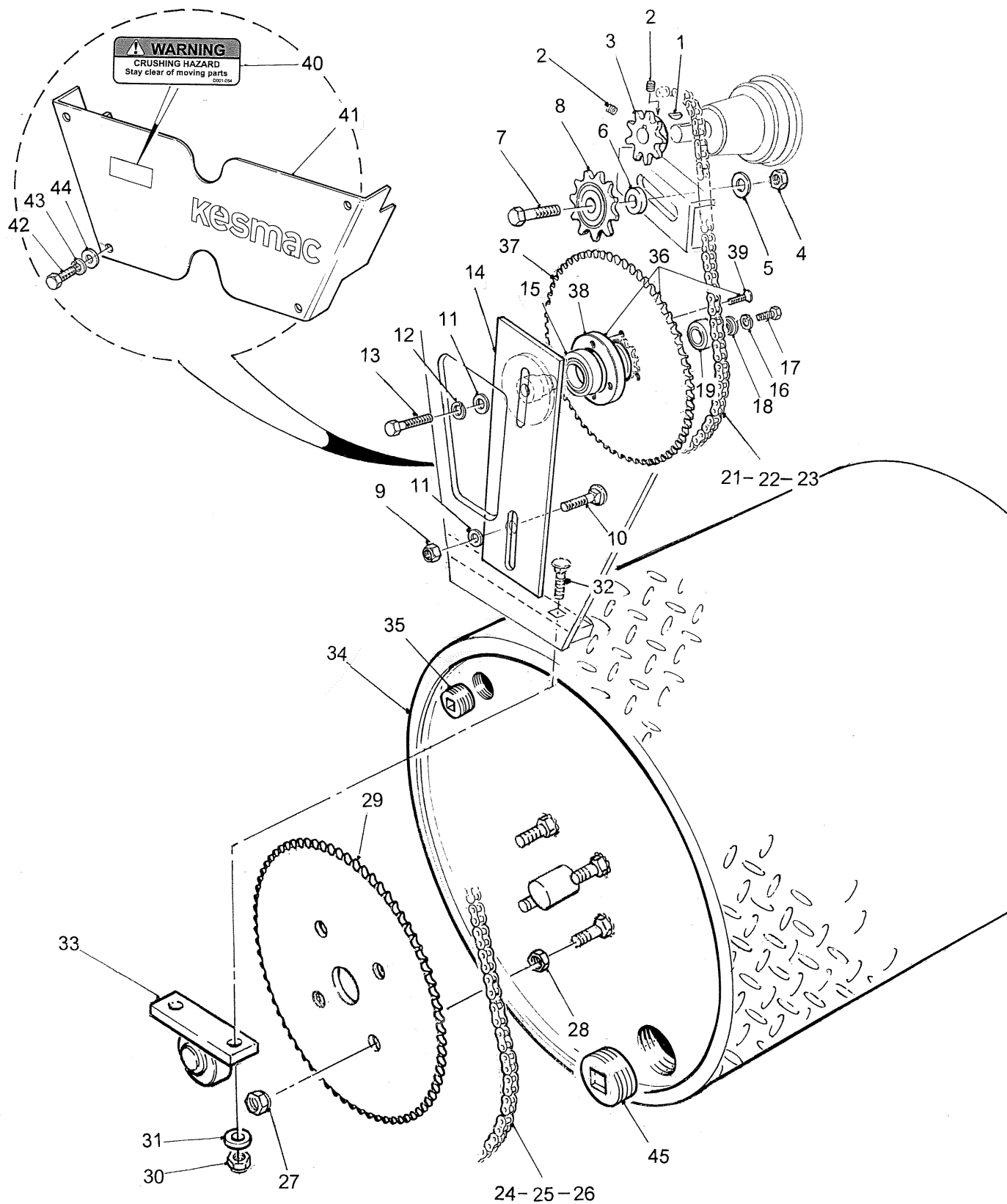

ITEM NO.	PART NO.	DESCRIPTION	QTY
		KTR 30 TURF ROLLER DRIVE SPROCKETS & CHAINS	
1	F900404	Woodruff Key 1/8 z 1/2	1
2	F140402	Set Screw 1/4 unc Soc. Hd.	2
3	TR10029	Drive Sprocket	1
4	F211000	Locknut 5/8 unc	1
5	F321000	Washer 5/8	2
6	TR10089	Spacer	1
7	F041024	Bolt 5/8 unc x 2 1/2 Gr.8	1
8	KD70003	Sprocket 18 T c/w Bearing	1
9	F210700	Locknut 7/16 unc	1
10	F020710	Carriage Bolt 7/16 unc x 1	1
11	F320600	Washer 3/8	1
12	F310700	Lockwasher 7/16	1
13	F040716	Bolt 7/16 unc x 1 3/4 Gr.8	1
14	TR30067	Sprocket Spindle	1
15	KB50003	Bearing	1
16	F310400	Lockwasher 1/4	1
17	F040406	Bolt 1/4 unc x 3/4 Gr.8	1
18	TR10005	Retaining Washer	1
19	KB11623	Bearing	1
20	TR30025	Intermediate Sprocket - Obsolete (Replaced by Item 36.)	1
21	KD71001	Chain Half Link #40 (if required)	1
22	KD71000	Chain Connecting Link #40	1
23	TR10096	Chain #40 Intermediate Sprocket to Transmission 39 1/2 in.	1
24	KD41001	Chain Half Link #50 (if required)	1
25	KD41000	Chain Connecting Link #50	1
26	TR10097	Chain #50 Roller to Int. Sprocket 48 1/2in.	1
27	F260800	Wheel Nut 1/2 unf	4
28	F220850	Jam Nut 1/2 unf	4
29	TR10027	Sprocket 72T (24in. Dia. Roller)	1
30	F210700	Locknut 7/16 unc	4
31	F320700	Washer 7/16	4
32	F020716	Carriage Bolt 7/16 unc x 1 3/4	4
33	MB30001	Bearing - Pillow Block	2
34	TR30010	Roller - 24 in. Dia. (Traction)	1
	TR30180	Roller - 24 in. Dia. (Smooth)	1
	TR30183	Roller - 24 in. Dia. (Traction. Heavy Duty)	1
35	KH00015	Pipe Plug 3/4 NPT. Sq. Hd. (Qty. 2 on early models)	1
36	TR50249	Intermediate Sprocket Assembly. See Note 2	1
37	TR10116	Intermediate Sprocket	1
38	TR10026	Sprocket	1
39	F120510	Bolt 5/16 x 1 Flat Hd. Hex Soc.	4
40	D001-054	Decal - "Warning Crushing Hazard..."	1
41	TR10098	Chain Guard. Lower	1
42	F040406	Bolt 1/4 unc x 3/4 Gr.8	4
43	F310400	Lockwasher 1/4	4
44	F320400	Washer 1/4	4
45	KH00026	Pipe Plug 2 NPT. Recessed Sq. Hd.	1

NOTE 1

TR30010 - Not Available.
Replaced by Assembly TR50408.
TR30180 - Not Available.
Replaced by Assembly TR50409.
TR30183 - Not Available.
Replaced by Assembly TR50410.

See Note 1

NOTE 2

Use Part No. TR50322 to
order the Intermediate
Sprocket Assembly c/w
Bearings.

CONTROLS ASSEMBLY

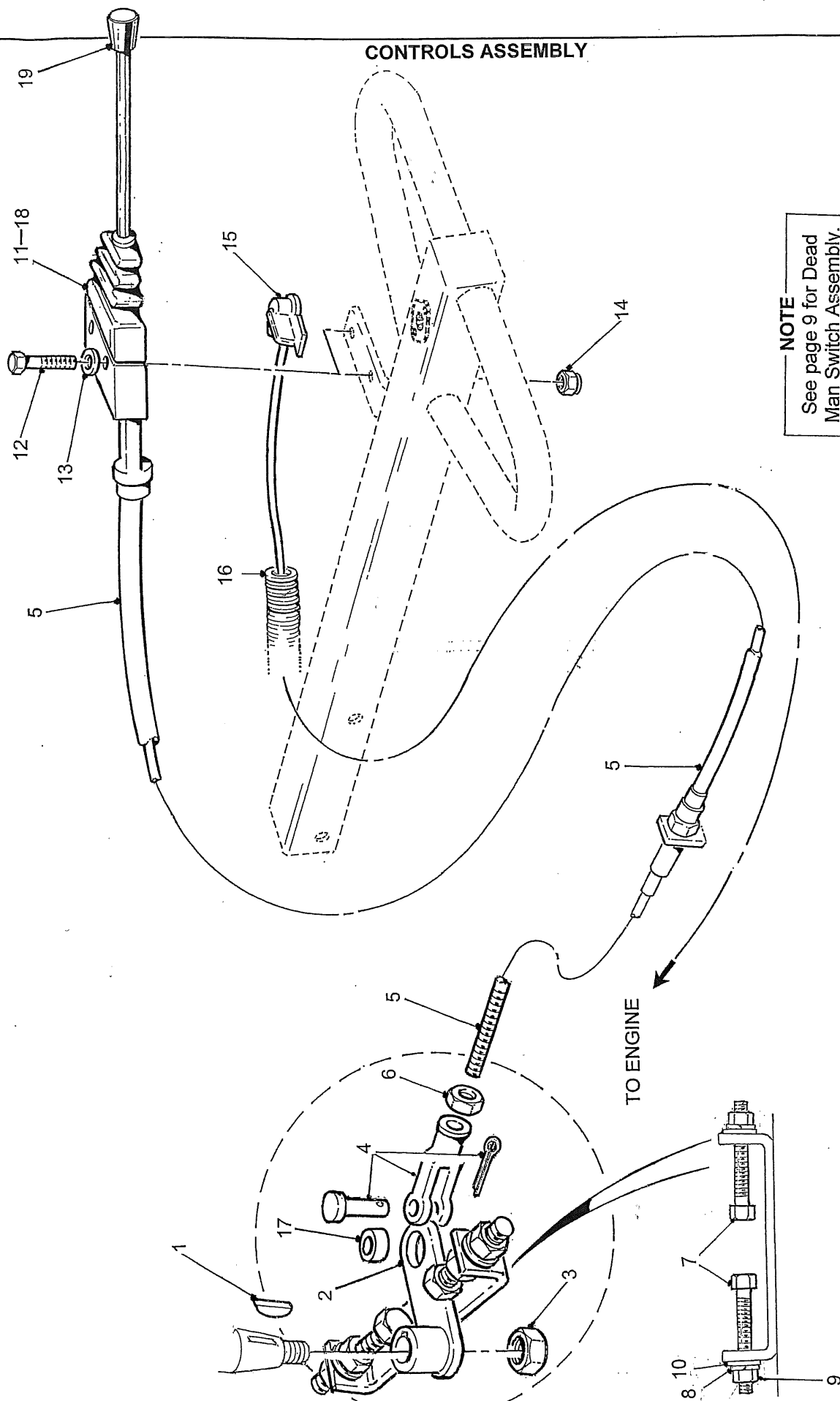

NOTE
See page 9 for Dead
Man Switch Assembly.

ITEM NO.	PART NO	DESCRIPTION	QTY
		KTR 30 TURF ROLLER CONTROLS ASSEMBLY	
1	F900404	Woodruff Key 1/8 x 1/2	1
2	TR30045	Lever Arm	1
3	F230600	Nut 3/8 UNC (Locite)	1
4	KD10026	Clevis Cable End c/w Pin, Cotter Pin & Bushing	1
5	KD10028	Control Cable Ass'y (Non Current to Serial No.19)	1
	KD10033	Control Cable Ass'y (Current Serial No.20 onward)	1
6	F220450	Jam Nut 1/4 - 28 UNF	1
7	F010516	Bolt 5/16 UNC x 1 3/4	2
8	F310500	Lockwasher 5/16	2
9	F230500	Nut 5/16 UNC	2
10	F320400	Washer 1/4	2
11	TR50195	F-N-R Control Assembly c/w Cable	1
	KD10027	Control Assembly. F-N-R	1
12	F040522	Bolt 5/16 unc x 2 1/2 Gr.8	2
13	F320400	Washer 1/4	4
14	F210500	Locknut 5/16	2
15	KD40025	Switch 'ON-OFF' (Honda Part)	1
16	TR50188	Loom 'ON-OFF' Switch to Engine	Ref
17	KB10404	Bushing	1
18	KD10044	Control Assembly. Service Kit	1
19	KM99055	Knob	1

NOTE

Item 18 - Control Assembly Service Kit includes a Bolt, Lockwasher, Cable End Bushing - KB10422, and Snap Ring - F830425.

ENGINE & TRANSMISSION ASSEMBLY

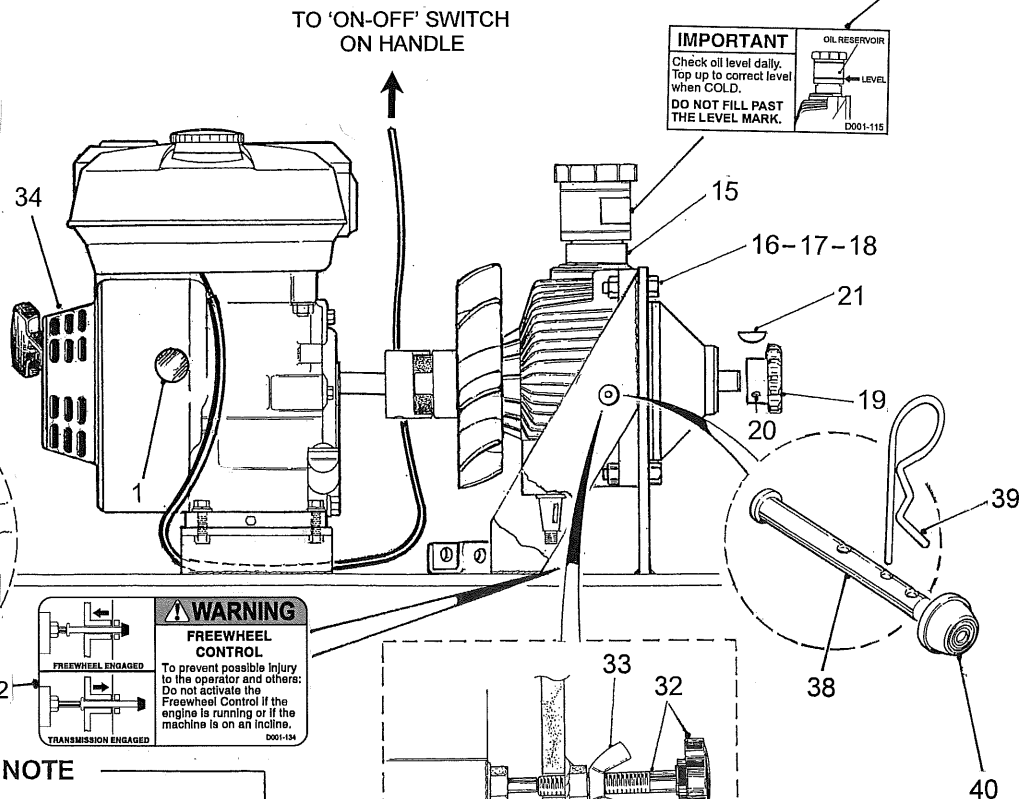
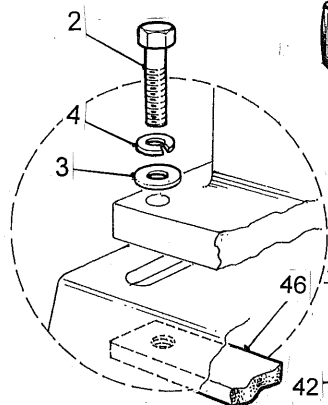
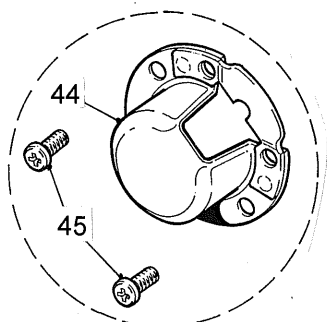
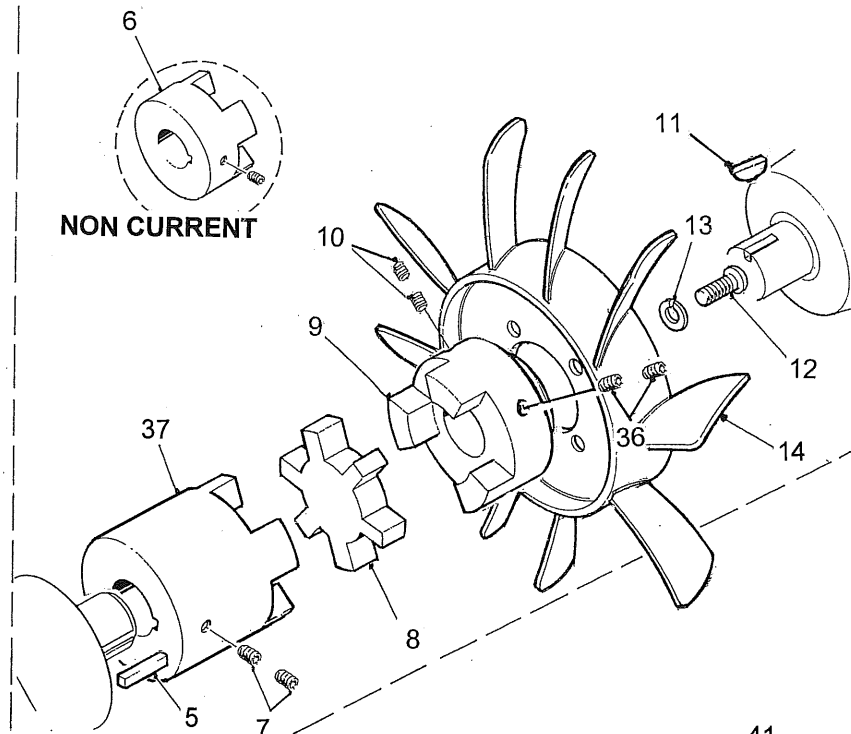
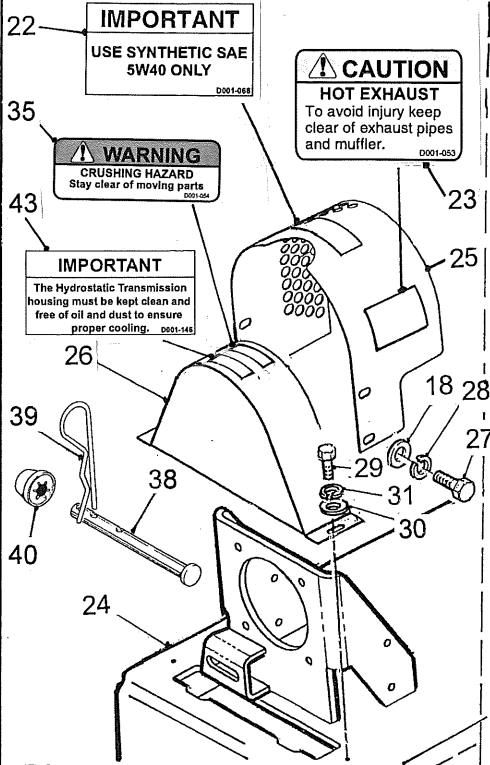

NOTE

Replacement parts for the Eaton transmission must be ordered from the Eaton dealer in your area. Go to www.eatonhydraulics.com for information.

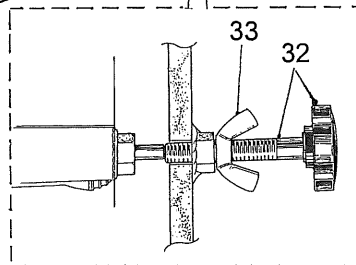

ITEM NO.	PART NO	DESCRIPTION	QTY
KTR 30 TURF ROLLER ENGINE & TRANSMISSION ASSEMBLY			
1	KM30012	Plug	1
2	F010516	Bolt 5/16 UNC x 1 3/4	4
3	F320400	Washer 1/4	4
4	F310500	Lockwasher 5/16	4
5	F923310	Key 3/16 x 3/16 x 1 (Engine shaft)	1
6	KD85006	Half Coupling (Engine) - Non Current to Serial No. 305	1
7	F140502	Set Screw UNC 5/16 Soc. Hd.	2
8	KD85104	Coupling Insert	1
9	TR10028	Half Coupling (Transmission)	1
10	F140402	Set Screw 1/4 UNC Soc. Hd.	2
11	F900404	Woodruff Key 1/8 x 1/2	2
12	F700204	Screw #10 - 24 x 1/2	4
13	F310200	Lockwasher #10	4
14	TR10177	Cooling Fan	1
15	KD40017	Transmission (Eaton Model 7)	1
16	F010632	Bolt 3/8 UNC x 3 1/4	4
17	F210600	Locknut 3/8 UNC	4
18	F320500	Washer 5/16	8
19	TR10029	Sprocket (Transmission Shaft)	1
20	F140402	Set Screw 1/4 UNC Soc. Hd.	2
21	F900404	Woodruff Key 1/8 x 1/2	1
22	D001-068	Decal - "Important Use Synthetic..."	1
23	D001-053	Decal - "Caution Hot Exhaust..."	1
24	TR30033	Roller Housing	1
25	TR10030	Fan Shroud	1
26	TR30039	Chain Guard	1
27	F040606	Bolt 3/8 unc x 3/4 Gr.8	4
28	F310600	Lockwasher 3/8	4
29	F040406	Bolt 1/4 unc x 3/4 Gr.8	2
30	F320400	Washer 1/4	2
31	F310400	Lockwasher 1/4	2
32	TR50194	Knob Thumbscrew Adjuster Assembly. Non Current up to Serial No. 450	1
33	F420601	Wing Nut. Non Current up to Serial No. 450	1
34	KD40019	Honda Engine GX 160 - See Note on Front Page of Parts List	1
35	D001-054	Decal - "Warning Crushing Hazard..."	1
36	F140502	Set Screw 5/16 unc x 1/4	2
37	TR10239	Half Coupling (Engine) - Current from Serial No. 306	1
38	TR10320	Pin. Free Wheeling. Current from Serial No. 451	1
39	F940224	Hitch Pin Clip. Current from Serial No. 451	1
40	KX50105	Push Cap Nut. Current from Serial No. 451	1
41	D001-115	Decal - "Important Check Oil Level..."	1
42	D001-134	Decal - "Warning Freewheel Control..." Current from Serial No. 451	1
43	D001-146	Decal - "Important Keep Hydrostatic Transmission clean..."	1
44	KD40020	Exhaust Deflector. Honda Engine GX 160	1
45	KD40021	Screw. Exhaust Deflector	2
46	TR10170	Nut Bar	2

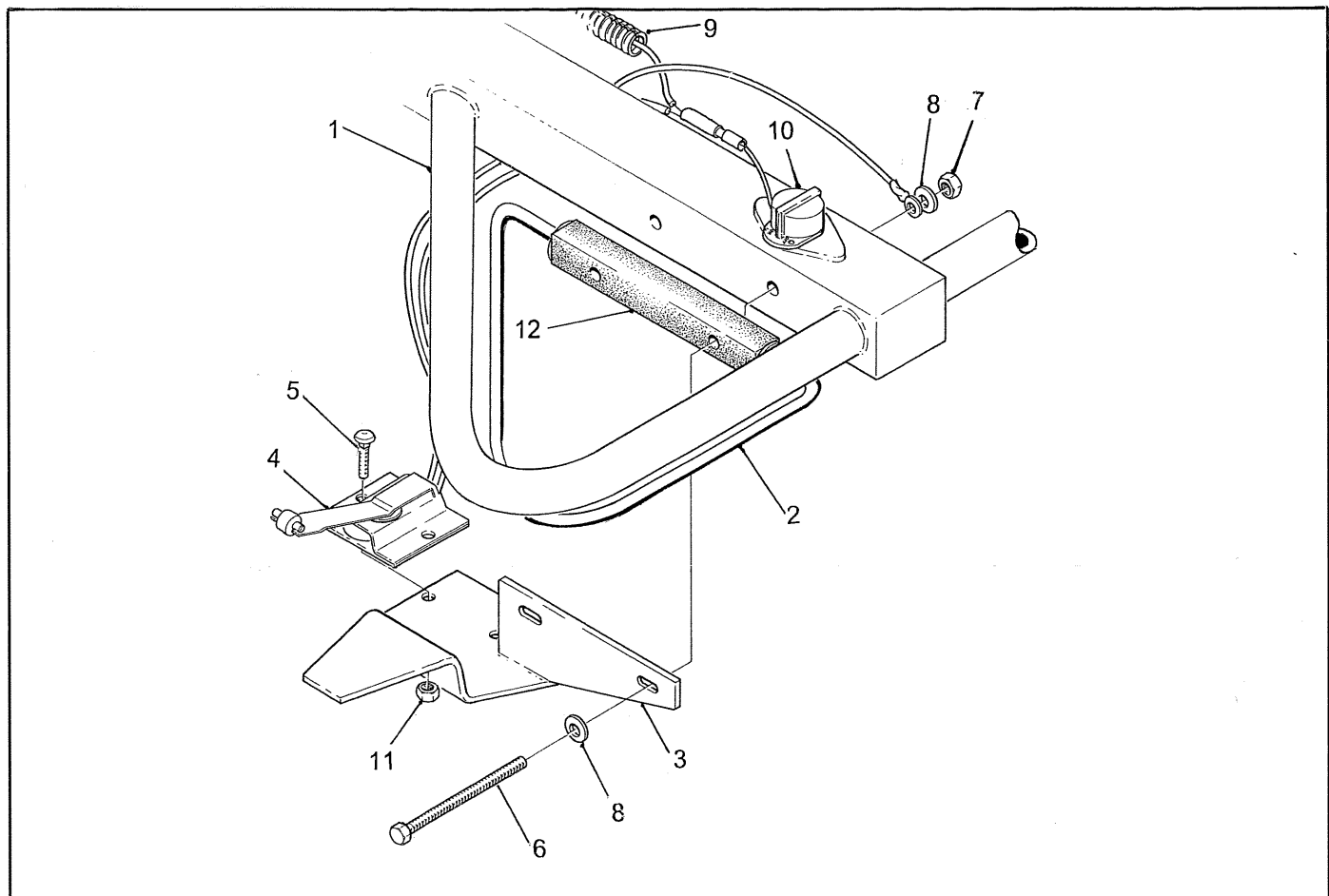
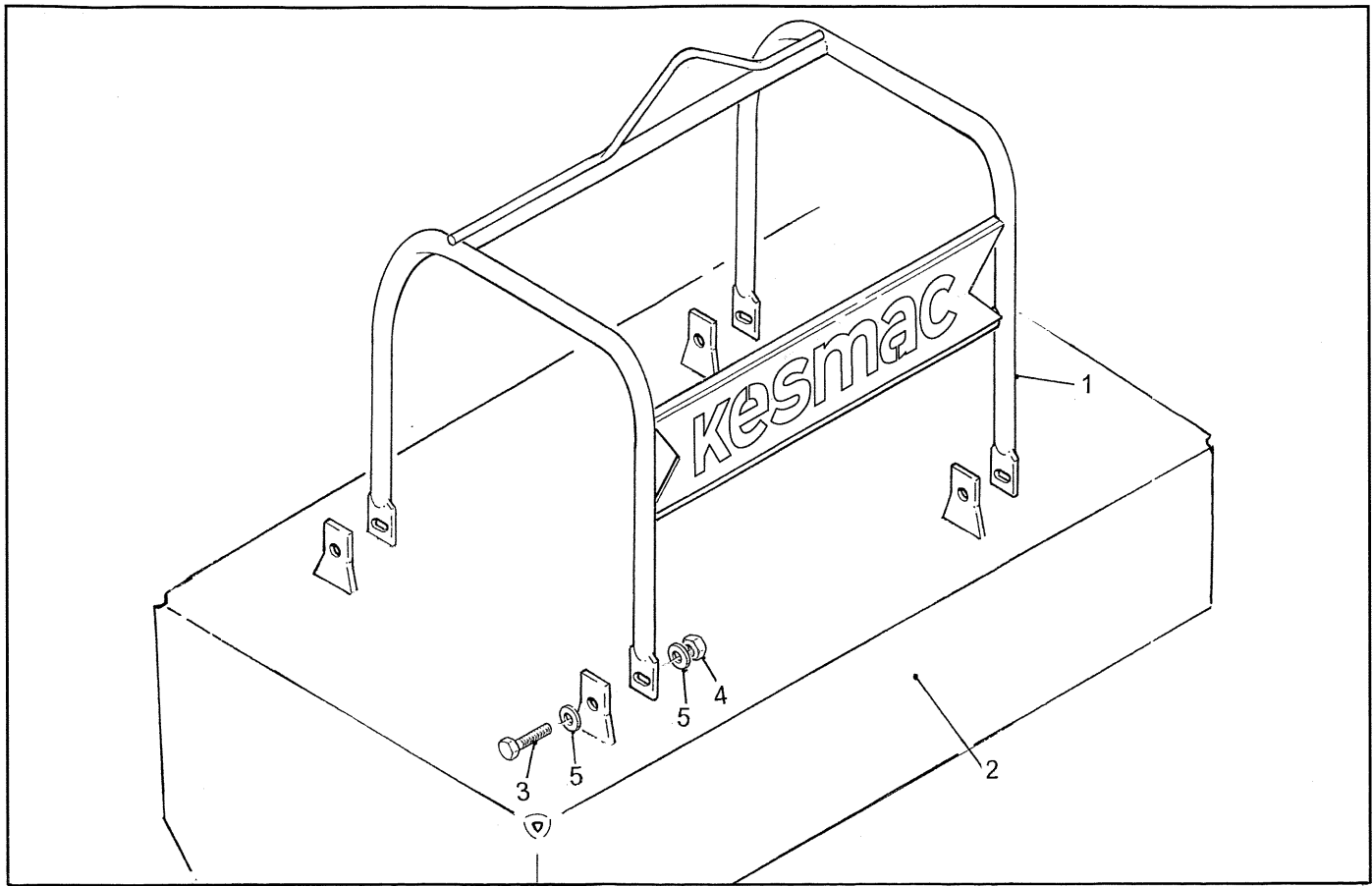

ITEM NO.	PART NO.	DESCRIPTION	QTY
POWER PROTECTION ASSEMBLY			
1	TR30106	Roll Cage	1
2	TR30033	Roller Housing	1
3	F040612	Bolt- 3/8 unc x 1 1/4 Gr. 8	4
4	F230600	Nut 3/8 unc	4
5	F320500	Washer 5/16	8

ITEM NO.	PART NO.	DESCRIPTION	QTY
DEAD MAN SWITCH ASSEMBLY			
1	TR30083	Handle	1
2	TR30099	Dead Man Handle	1
3	TR30101	Switch Mounting Bracket	1
4	KE80005	Limit Switch	1
5	F580204	Bolt- #10 St. Stl. Pan Hd.	2
6	F040440	Bolt- 1/4 unc x 4 Gr. 8	2
7	F230400	Nut- 1/4 unc	2
8	F320400	Washer 1/4	4
9	TR50188	Loom Assembly	1
10	KD40025	ON-OFF' Switch	1
11	F210300	Locknut #10	2
12	TR10100	Pivot Mount. Dead Man Handle	1

ITEM NO.	PART NO.	DESCRIPTION	QTY
		KTR 30 TURF ROLLER "RIDE ON" ACCESSORY Available from Serial Number 467	
	TR50318	"Ride On" Accessory. Assembly	1
1	TR30033	Roller Housing	Ref.
2	TR30284	Handle	1
3	F040840	Bolt 1/2 unc x 4 Gr.8	2
4	F320800	Washer 1/2	4
5	F310800	Lockwasher 1/2	1
6	F210800	Locknut 1/2 unc	4
7	TR30199	Pivot Frame	1
8	F040854	Bolt 1/2 unc x 5 1/2 Gr.8	2
9	F040612	Bolt 3/8 unc x 1 1/4 Gr.8	4
10	F310600	Lockwasher 3/8	4
11	TR30203	Pivot Clevis	1
12	F211600	Locknut 1 in.-14 uns	1
13	TR30207	Roller Frame. 8 in.	1
14	F040814	Bolt 1/2 unc x 1 1/2 Gr.8	2
15	F220800	Jamnut 1/2 unc	4
16	F121016	Bolt 5/8 unc x 1 3/4 Soc. Hd. Gr.8	4
17	F321000	Washer 5/8	4
18	F211000	Locknut 5/8 unc	4
19	TR30214	Platform	1
20	F040820	Bolt 1/2 unc x 2 Gr.8	2
21	F040720	Bolt 7/16 unc x 2 Gr.8	2
22	F320700	Washer 7/16	4
23	F210700	Locknut 7/16 unc	4
24	F120720	Bolt 7/16 unc x 2 Sod. Hd. Gr.8	2
25	F040610	Bolt 3/8 unc x 1 Gr.8	2
26	F220600	Jamnut 3/8 unc	2
27	TR30312	Backrest. Mounting Bracket. L.H.	1
28	TR30313	Backrest. Mounting Bracket. R.H.	1
29	F040720	Bolt 7/16 unc x 2 Gr.8	2
30	F380700	Shimwasher 3/8	4
31	F320600	Washer 3/8	6
32	F210600	Locknut 3/8 unc	4
33	TR30314	Support Base. L.H.	1
34	TR30315	Support Base. R.H.	1
35	F040630	Bolt 3/8 unc x 3	2
36	TR10247	Backrest	1
37	TR10056	Scraper 8 in. Roller	1
38	F040406	Bolt 1/4 unc x 3/4 Gr.8	7
39	F320400	Flatwasher 1/4	7
40	TR10316	Foot Guard. Roller	1
41	TR10317	Foot Guard. Platform	1
42	TR10321	Cushion Cover. Backrest	1
43	TR10324	Inner Padding. Backrest	1
44	TR10325	Outer Padding. Backrest	1
45	TR10326	Foot Pad	1
46	KS50001	Isolator	2
47	TR10329	Retainer. Foot Pad	1
48	F580406	Bolt 1/4 unc x 3/4 Pan Hd. Lg.	3
49	F210400	Locknut 1/4 unc	3

NOTE

Turf Rollers with the serial numbers 355, 429 & 439 are also equipped with the 'Ride On' accessory.

**Eaton
Hydraulics
Division**

Parts Information

Model 7 Eaton Hydrostatic Transmission

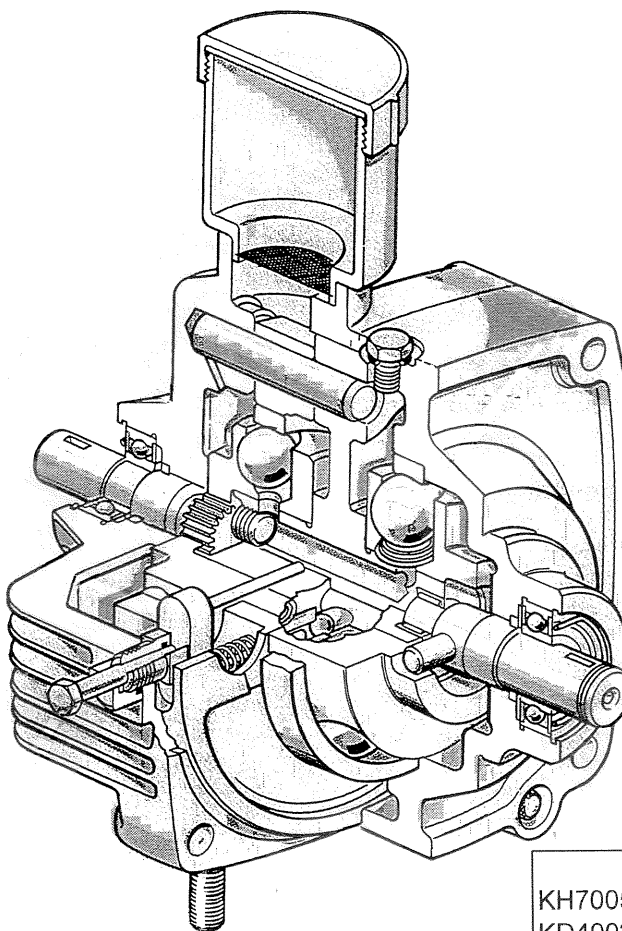

NOTE

KH70055 Transmission Overhaul Kit & KD40023 Reservoir Kit can be ordered from Kesmac parts department. ALL OTHER TRANSMISSION PARTS ARE LISTED FOR CUSTOMER CONVENIENCE, BUT **MUST** BE ORDERED FROM THE EATON AREA DEALER.
go to www.eatonhydraulics.com for more information

EAT•N

NOTE

Items 1A & 1 can be ordered from
Kesmac parts department.
ALL OTHER TRANSMISSION PARTS
ARE LISTED FOR CUSTOMER
CONVENIENCE, BUT **MUST** BE
ORDERED FROM THE EATON AREA
DEALER.

go to www.eatonhydraulics.com for
more information

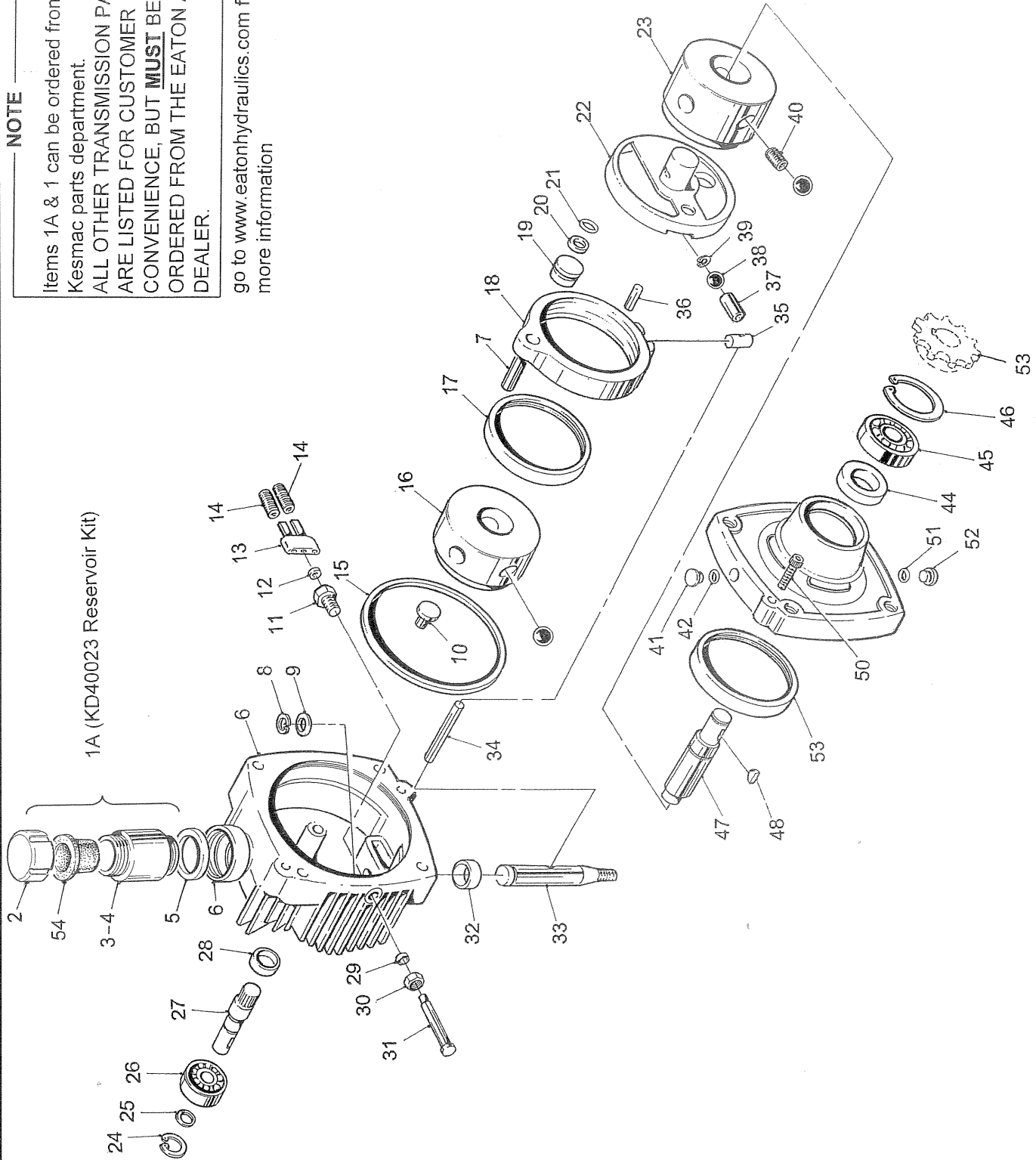

ITEM NO.	PART NO.	DESCRIPTION	QTY
		EATON MODEL 7 HYDROSTATIC TRANSMISSION	
1	KH70055	Transmission Overhaul Kit	
1A	KD40023	Transmission Reservoir Kit	1
2	103531	Reservoir Cover	1
3	104322	Reservoir Body	1
4	104068	Reservoir Diaphragm	1
5	008771-130	Square Cut Seal Ring	1
6	990176	Cover Service Kit	1
7	93881	Pivot Pin Dowel	1
8	096098-062	External Retaining Ring	1
9	95060	Control Shaft Washer	1
10	101597	Button	1
11	24234	'O' Ring Fitting Guide Sub-assembly	1
12	008761-010	'O' Ring	1
13	24166	Bracket - Pins Sub-assembly	1
14	72149	Valve Spring	2
15	008771-162	Square Cut Seal Ring	1
16	22712	Pump Rotor - Ball Sub-assembly	1
17	40520	Pump Race	1
18	102623	Cam Ring	1
19	102451	Piston	2
20	088770-113	Back-up Ring	2
21	008765-113	'O' Ring	2
22	102454	Pintle Sub-assembly	1
23	104111	Motor Rotor- Ball Sub-assembly	1
24	101680-156	Retaining Ring	1
25	97121	Snap Ring	1
26	90797	Ball Bearing (Input)	1
27	62184	Input Shaft	1
28	93955	Oil Seal	1
29	82112	Gasket	1
30	24235	Nut - Gasket Sub-assembly	1
31	62240	Dump Valve Shaft	1
32	93895	Oil Seal	1
33	990083	Control Shaft Kit	1
34	990083	Dowel 3/8 dia. x 1 3/4 lg.	1
35	95203	Cam Ring Insert	1
36	098294-075	Coil Pin 5/16 dia. x 3/4 lg.	1
37	70130	Check Valve Body	2
38	0095881-031	Grade 200 Ball 5/16 dia.	2
39	95214	Retaining Ring	2
40	70044	Piston Spring	5
41	025090-006	'O' Ring Plug Sub-assembly	1
42	008785-006	Tube Fitting 'O' Ring	1
43	32278	Body	1
44	93955	Oil Seal	1
45	90797	Ball Bearing (Output)	1
46	101680-156	Retaining Ring	1
47	22892	Output Shaft Sub-assembly	1
48	N/A	Woodruff Key #3	1

NOTE

Items 1A & 1 can be ordered from Kesmac parts department.
ALL OTHER TRANSMISSION PARTS ARE LISTED FOR CUSTOMER CONVENIENCE, BUT **MUST** BE ORDERED FROM THE EATON AREA DEALER.

go to www.eatonhydraulics.com for more information

NOTE

Items 1A & 1 can be ordered from
Kesmac parts department.
ALL OTHER TRANSMISSION PARTS
ARE LISTED FOR CUSTOMER
CONVENIENCE, BUT **MUST** BE
ORDERED FROM THE EATON AREA
DEALER.

go to www.eatonhydraulics.com for
more information

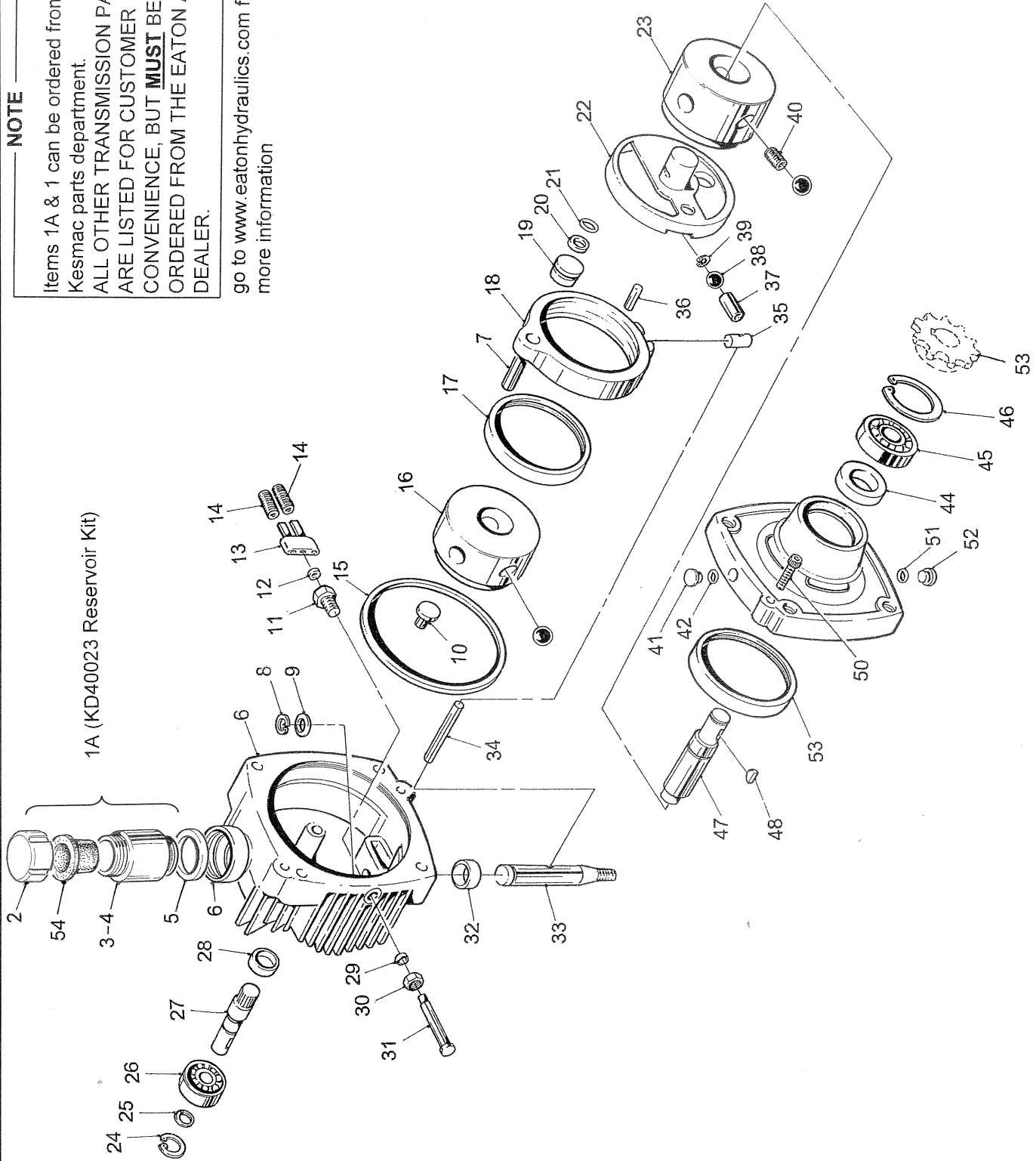

ITEM NO.	PART NO.	DESCRIPTION	QTY
		EATON MODEL 7 HYDROSTATIC TRANSMISSION	
49	40519	Motor Race	1
50	095912-125	Socket Hd. Capscrew	2
51	008785-006	Tube Fitting 'O' Ring	1
52	025090-005	'O' Ring Plug Assembly	1
53	TR10029	Sprocket (Transmission Shaft)	ref
54	KD40033	Diaphram. Reservoir - Current from Serial No. 450	1

EATON®
MODEL 7
HYDROSTATIC PUMP
PARTS INFORMATION
NO. 6-606

HOW TO ORDER
REPLACEMENT PARTS

EACH ORDER MUST INCLUDE
THE FOLLOWING INFORMATION

1. Product Number
2. Date Code
3. Part Name
4. Part Number
5. Quantity of Parts

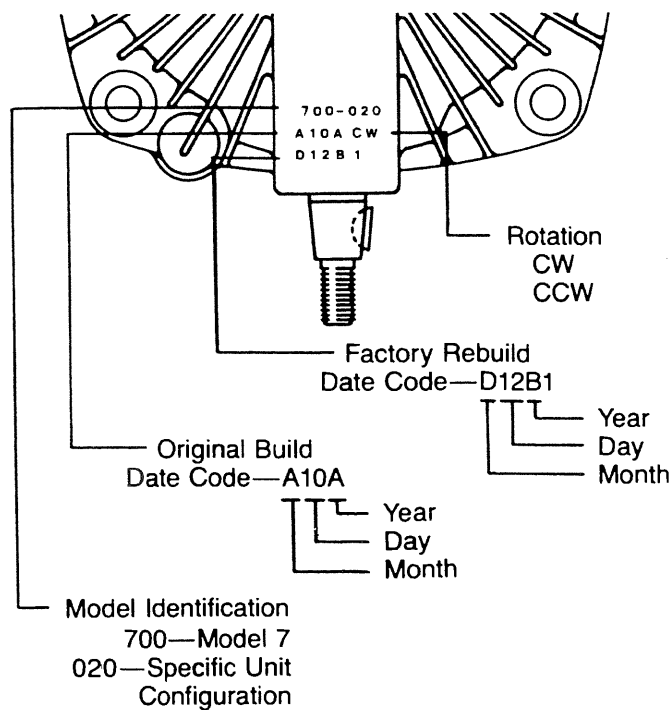

Eaton Corporation **Hydraulics Division** 15151 Highway 5 Eden Prairie, MN 55344 Telephone (612) 937-9800

EAT•N