

To Order Call: 1-800-250-5688

MCCULLOUGH COVER-UP  
SERIES 1600

# Operation and Maintenance Manual

Parts Catalog  
1600 Series

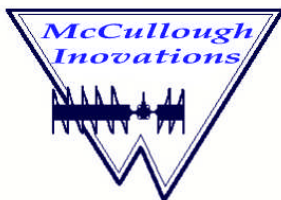

## MCCULLOUGH COVER-UP SERIES 1600

1101 Sheppard Road

Burkburnett, Tx 76354  
Phone 1-940-569-1770  
Fax 1-940-563-5772



## MCCULLOUGH COVERUP

- Complete Operation and maintenance manual for the McCullough Coverup
- 1600 Parts list included.

Call Toll Free: 1-800-250-5688

09/05/04

## Contents

---

Page	
3.	Foreword
4.	Support
5.,6.	Warranty
7.	Introduction
8,9,10.	Safety
11.	Operation
12	Troubleshooting
13,14,15.	Parts List
16	Specifications
17.	Other Products
18.	Registration

## Other products Series 1500 & 2000

---

### 2000 Series

The **2000** series was developed to handle the larger jobs of backfilling associated with the medium size trenchers. The 2000 can be adapted to nearly all of the skid steer loaders as shown and some trenchers such as the 3700 Ditch Witch.



#### Specifications:

Overall Length:	66"	Auger Width:	54"
Auger Diameter	12"	Weight	350 lbs.
Auger Choices:	Offset Right, Offset Left, Centered		
HP @ 15 GPM:	20		

### 1500 Series

The **1500** series is a smaller version of the **1600** series for the operator that needs less width and weight. The 1600 is also used with the smaller skid steer loaders and tractors

#### Specifications:

Overall Length:	49"
Auger Width:	41"
Auger Diameter:	12"
Auger Choices:	Centered,



Offset right , offset left

HP @ 10 GPM	11.4
Weight :	250 Lbs.

**1600 SERIES SPECIFICATIONS**

OVERALL LENGTH	56 1/2"
AUGER WIDTH	46 1/2"
VERTICAL FLOAT MOVEMENT	7 "
AUGER DIAMETER	12"
NUMBER OF INTERTWINED FLIGHTS	3
DRIVE	DYNAMIC
HP @ 15GPM @ 3000 PSI	17.1
GAUGE WHEEL	2" X 6"
HOSES 3000PSI	1/2 " X 60"
FINISH =	POWDER COATED
OVERALL HEIGHT (BACK PLATE LOWEST POSITION)	15 1/2"
OVERALL HEIGHT (BACK PLATE HIGHEST POSITION)	20 1/4"
CENTER OPENING WIDTH	4"
WEIGHT	250 LBS
HP @ 10 GPM @ 3000 PSI	11.4
SIDE LOAD CAPACITY	2400 LBS
LOAD CAPACITY EACH	1200 LBS
CONSTRUCT	STEEL, 1/8 AND 1/4

## Operator's manual

### Warranty

#### PRODUCT SUPPORT POLICY

FOR A PERIOD OF 90 DAYS FROM THE DATE OF DELIVERY BY THE DEALER TO THE ORIGINAL PURCHASER, MCCULLOUGH COVERUP WILL PROVIDE FREE REPLACEMENT PARTS THROUGH THE MCCULLOUGH COVERUP DEALER FOR ANY MCCULLOUGH COVERUP PART CONTAINING A DEFECT IN MATERIAL OR WORKMANSHIP.

Major components will have coverage for 1 year. Major components for the McCullough Coverup are defined as: **frame, augers, and wheels.** Owner's responsibility to qualify for product support are:

- Train operators according to operator's manual.
- Maintain machine according to operators manual.
- Use unit for designed applications only.

This product support policy is limited to parts returned to the dealer and determined defective on inspection by McCullough. This policy does not include transportation charges or freight and does not include consequential damages or parts damaged by improper installation, misuse, or neglect.

There are no warranties which extend beyond this description.

The engine and engine accessories and transaxle accessories are covered by the original manufacturers warrant and are not covered by McCullough Coverup.

The McCullough Coverup has been tested in various conditions for satisfactory performance. This testing does not guarantee that the equipment will perform in all conditions satisfactorily. Adequacy of the equipment for your situation should be determined before purchase.

## BACK PLATE AND FLOAT BAR ASSEMBLY

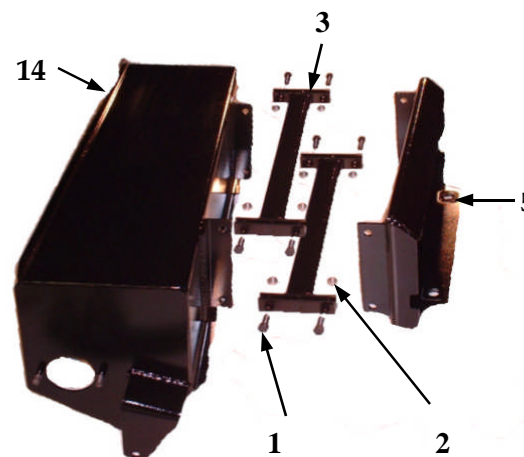

### 1600 SERIES PARTS LIST

No.	Part #	Description
1 ---	1601	1/2 x 1 1/2 #5 Bolt
2 --	1602	1/2" Lock Nut
3 --	1603	Float Bar
5 --	1605	Universal Adapter Plate
14 --	1614	Main Frame and Cover

## RIGHT SIDE ASSEMBLY

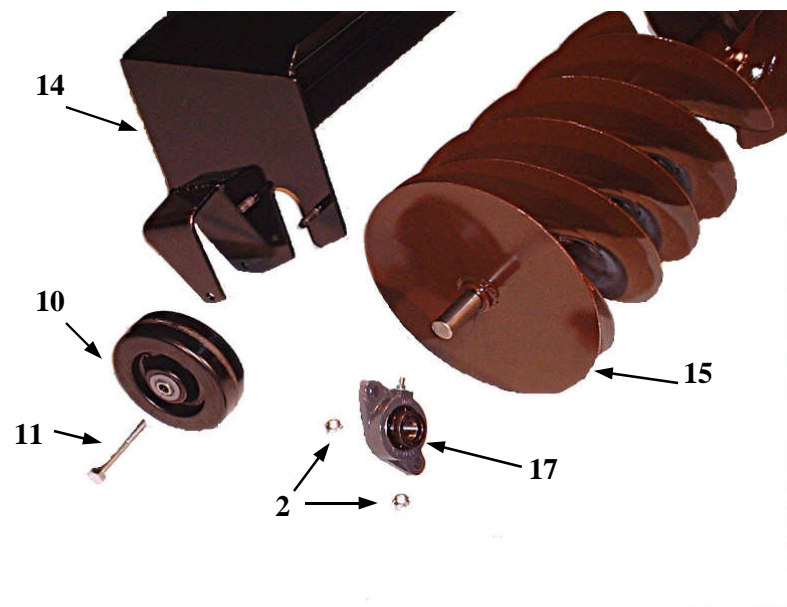

## 1600 SERIES PARTS LIST

No.	Part #	Description
2	--1602	1/2 Lock Nut
10	--1610	Gauge Wheel
11	--1611	1/2 x 3 1/2 #5 Bolt
14	--1614	Main Frame And Cover
15	--1615C	Auger, Center Opening
	1615R	Auger, Long Side on Right
	1615L	Auger, Long Side on Left
17	1617	2 Bolt Flange Bearing , 1"

## INTRODUCTION

Thank you for purchasing a McCullough Coverup 1600. Read this Manual carefully to learn how to operate and service your coverup machine correctly. Failure to do so could result in personal injury or equipment damage.

This Manual should be considered a permanent part of your coverup machine.

Measurements in this manual are US customary units.

Right and left sides are determined by facing in the direction of forward travel.

Record serial Numbers to help trace the machine if it is stolen. File Numbers in a safe place.

## SAFETY

### RECOGNIZE SAFETY INFORMATION

This is the safety-alert symbol. When you see this symbol on your machine or in this manual, be alert to the potential for personal injury.



Follow recommended precautions and safe operating practices. Use common sense.

### UNDERSTAND SIGNAL WORDS !

A signal word, DANGER OR CAUTION is used with the safety – alert symbol. DANGER OR WARNING safety signs are located near specific hazards. General precautions are listed on CAUTION safety messages in this manual.

### FOLLOW SAFETY INSTRUCTIONS

Carefully read all of this manual.

Learn how to operate the coverup machine and how to use controls properly. Do not let anyone operate the machine without instruction and training.

Keep equipment in proper working condition. Unauthorized modifications to the coverup machine may impair the function and/or safety and affect the machine life.

If you do not understand any part of this manual and need help, contact your sales representative.

## LEFT SIDE ASSEMBLY

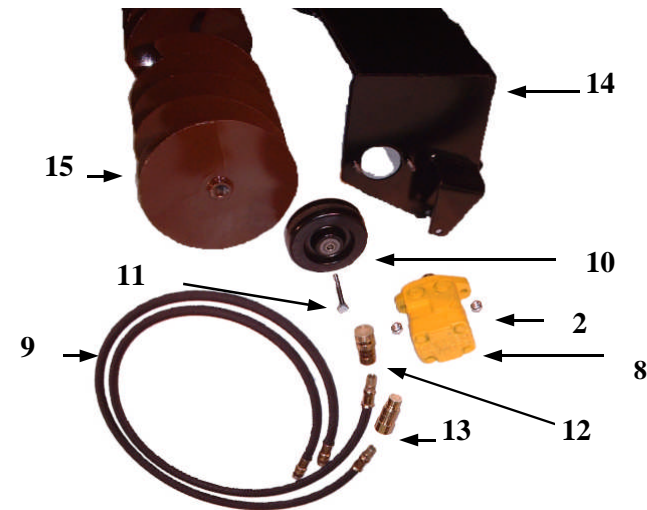

## 1600 SERIES PARTS LIST

No.	Part #	Description
2--	1602	1/2" Lock Nut
8--	1608	White Hydraulic Motor
9--	1609	1/2 X 60" Hydraulic Hoses
10--	1610	Gauge Wheel
11--	1611	1/2 X 3 1/2 #5 Bolt
12--	1612	1/2 Female Quick Coupler
13--	1613	1/2 Male Quick Coupler
14--	1614	Main Frame and Cover

## TROUBLE SHOOTING

---

### IF AUGER DOESN'T TURN

Check hydraulic lines and hydraulic Flow.

Check woodruff key on motor shaft. If the key has sheared, remove motor and replace key.

Shut Engine down and check auger for any foreign objects.

### INSPECT COVERUP MACHINE BEFORE YOU OPERATE IT.

Check for loose, worn, damaged, or missing parts and correct any problems before operating the coverup.



---

### PROTECT CHILDREN

Keep children and others away when using your coverup machine.

Before engaging controls stop and make sure area is free of children.

Do not let children ride on coverup machine.

---

### AVOID ROTATING AUGERS

Do not put hands or feet near augers—especially when auger is engaged and turning.

Do not attempt to clear objects from auger with engine running.

Remove objects that may become lodged in auger.

Always stop engine before attempting to adjust auger.

**LISTEN ! LOOK ! WAIT !**

**LISTEN** for sound of rotating auger before you approach coverup.



**LOOK** at auger and be sure that it is stopped.



**WAIT** to be sure all parts have stopped moving before approaching

**SERVICE COVERUP MACHINE SAFELY**

Understand service procedure before you do the work.

Keep work area floor clean and dry.

Help prevent injury from moving parts during service:

- Do not lubricate or service machine while parts are moving.
- Keep hands, feet, and clothing from power-driven parts.
- Disengage power.

**KEEP ALL PARTS IN GOOD CONDITION AND PROPERLY INSTALLED**

- Fix damage immediately.
- Replace worn or broken parts.
- Remove grease, oil , or dirt from parts.

**Operation****CONNECTING ATTACHMENT**

1. Hook coverup attachment to mounting plate and secure pins.
2. Connect hoses.
3. Turn on hydraulics and check rotation of auger.
4. Look at end of the machine where motor is attached. Auger should be turning clockwise.
5. Center arrow with ditch.

**ATTACHMENTS WITH PARALLEL BARS**

Let the boom down until the parallel bars are parallel with the ground.

Rotate tilt control until desired auger height is reached. Drive forward.

Parallel bars have a 7" float, so boom may need to be adjusted to keep parallel with the ground.

**ATTACHMENTS WITHOUT PARALLEL BARS**

Center on ditch.

Put the boom control in float position.

Use tilt control to regulate the height from ground.

Drive forward.